



**SEVENTH  
INTERNATIONAL  
CONFERENCE:** **MÉRIDA** MEXICO

**SUNDAY, OCTOBER 6—  
TUESDAY, OCTOBER 8, 2013**

The Association for Behavior Analysis International contributes to the well-being of society by developing, enhancing, and supporting the growth and vitality of the science of behavior analysis through research, education, and practice.

# Table of Contents

Schedule Overview .....	3
Welcome to the Seventh International Conference .....	4
Conference Program Committee .....	5
Partnerships.....	7
ABAI Executive Council .....	9
Registration and Continuing Education .....	10
About Poster Sessions .....	11
<b>Sunday, October 6 .....</b>	<b>13</b>
Day Schedule .....	14
Opening Reception.....	15
<b>Monday, October 7.....</b>	<b>17</b>
Day Schedule .....	18
Conference Sessions.....	20
<b>Tuesday, October 8 .....</b>	<b>55</b>
Day Schedule .....	56
Conference Sessions.....	58
Area Index.....	76
Author Index .....	77
Hotel Fiesta Americana Map .....	84
Mérida Map.....	85
Notes .....	86

## Program Content

© 2013 Association for Behavior Analysis International. All rights reserved. No part of this publication may be reproduced, stored in a retrieval system, or transmitted in any form or by any means without the written permission of the Association for Behavior Analysis International. All advertisements are accepted and published on the representation of the advertiser and its agency that they are authorized to publish the entire contents thereof and that, to the best of their knowledge and belief, all statements made therein are true. Publication of any content or acceptance of advertisements in this book does not imply endorsement by ABAI. The opinions, beliefs and viewpoints expressed by the various authors and speakers in this book and during the conference do not necessarily reflect the opinions, beliefs, and viewpoints of ABAI or official policies of ABAI.

## Video Recording Policy

Please be aware that ABAI prohibits audio and video recording of conference events by any person or entity other than ABAI.

## Photo Release Policy

While at the ABAI Seventh International Conference, attendees may be photographed by an ABAI-approved photographer. The Association for Behavior Analysis International reserves the right to use the attendee's photograph(s) in any and all of its printed or electronic publications. Attendees may not make monetary or other claims against ABAI for the use of the photograph(s).

## Schedule Overview

Please visit the conference registration desk on Floor 1 in the Hotel Fiesta Americana to register and pick up your badge. Badges are required for entry into all conference events. General sessions will be held in the Hotel Fiesta Americana and the Preseidente Hotel; the poster session will be located in the Gran Salon Yucatan.

### Sunday, October 6, 2013

Registration desk open	2:00 pm–9:00 pm
Press conference	4:30: pm–5:30 pm
Opening reception	7:00 pm–9:00 pm

### Monday, October 7, 2013

Registration desk open	7:00 am–9:00 pm
Invited and breakout sessions	8:30 am–10:20 am
Break	10:30 am–11:00 am
Invited and breakout sessions	11:00 am–1:50 pm
Luncheon	2:00 pm–4:00 pm
Invited and breakout sessions	4:00 pm–6:50 pm
Poster session	7:00 pm–9:00 pm
Dance party	9:00 pm–11:00 pm

### Tuesday, October 8, 2013

Registration desk open	7:00 am–3:30 pm
Invited and breakout sessions	8:30 am–10:20 am
Break	10:30 am–11:00 am
Invited and breakout sessions	11:00 am–3:20 pm
Closing celebration	3:30 pm–4:00 pm

### Join the Conversation on Twitter!

We encourage guests of the Seventh International Conference to discuss their favorite speakers, share what they've learned, and interact with other attendees on Twitter using “#2013Merida.” Also, be sure to follow “@ABAIevents” for updates during the conference.



The Analysis of  
**VERBAL  
BEHAVIOR**

**Subscribe Today!**

Just \$43 to ABAI members!

[www.abainternational.org/journals/the-analysis-of-verbal-behavior.aspx](http://www.abainternational.org/journals/the-analysis-of-verbal-behavior.aspx)

# Welcome to the Seventh International Conference

ABAI welcomes you to the Seventh International Conference in Mérida, Mexico. This conference was organized in collaboration with Universidad de Veracruz, Universidad Nacional Autónoma de México, and Universidad de Guadalajara. Those interested in the philosophy, science, practice, and teaching of behavior analysis are sure to enjoy this outstanding educational conference!

The purpose of this meeting is to pursue the dissemination of behavior analysis and facilitate collaboration among, and networking opportunities for, behavior analysts in Mexico and around the world.

## About the ABAI

ABAI is the primary membership association for behavior analysts worldwide. The association supports and promotes the field of behavior analysis through the pursuit of its mission, “to contribute to the well-being of society by developing, enhancing, and supporting the growth and vitality of the science of behavior analysis through research, education, and practice.”

Founded in May 1974 at the University of Chicago, ABAI’s first annual convention was held the following year. The association has about 6,000 members from nearly 50 countries. Members learn from and interact with leaders in the field, are encouraged to share experiences and research with peers, and work to build educational strategies, discover new veins of research, and promote best practices.

ABAI provides a forum for 35 special interest groups, maintains a mutually beneficial relationship with 84 affiliated chapters located across the USA and from around the world, and organizes an annual convention in addition to other conferences and events. ABAI publishes three scholarly journals—*The Behavior Analyst*, *The Analysis of Verbal Behavior*, and *Behavior Analysis in Practice*; distributes a triannual members’ publication *Inside Behavior Analysis*, provides continuing education credits, and accredits behavior analysis undergraduate and graduate training programs.

ABAI members can save more than \$1,000 a year in discounts on conferences, workshops, journals, recordings in our learning center, professional liability insurance, hotels, rental cars, and computers. Through ABAI membership, the international community of behavior analysts supports the growth and vitality of the science of behavioral research, education, and practice.

Apply for membership and learn more about ABAI on the web at [www.abainternational.org](http://www.abainternational.org).

## Tours

Various tours will be offered during the conference. Please check with the tour desk at ABAI’s Registration area to book tours with our tour company, AmigoYucatan.

## Program Committee



Agustin Daniel Gómez Fuentes (Universidad Veracruzana) is the director of the Institute of Psychology and Education and a member of national and international academic societies like the Mexican System Research in Psychology (SMIP), the Mexican Society of Behavior Analysis, and ABAI. He is the coordinator of the Research Group of Human Behavior and leads the National Network of Human Experimental Psychology of SMIP and is a multiregional network member of Excellence Graduate Programs in Psychology.



Javier Nieto Gutiérrez (Universidad Nacional Autónoma de México) is a fulltime professor and the dean of the School of Psychology at the National University of Mexico. He works on Pavlovian and instrumental conditioning with rats and humans and is also interested in reinstatement of extinguished behaviors and its relation to addictive behaviors and relapse. He has served as president of the Mexican Society for Behavior Analysis and as general editor of the *Mexican Journal of Behavior Analysis*.



Martha Hübner (chair, Universidade de São Paulo) is an associate professor in experimental psychology at the Institute of Psychology, University of São Paulo and member of the council of Brazilian Society of Psychology and Brazilian Association of Behavioral Psychology. She conducts research at the Laboratory for the Study of Verbal Operants involving complex human processes in the acquisition of behaviors such as reading and verbal behavior, in general, with emphasis on autocalitics. She is the general coordinator of a public university behavioral program in autism, in Brazil.



Maria E. Malott (CEO, Association for Behavior Analysis International; CE coordination for licensed psychologists) has administered ABAI since 1993. During this time and within a few short years, ABAI has risen from near-bankruptcy to become a financially stable, growing scientific and professional organization. She has served on four editorial boards and is the author of the book *Paradox of Organizational Change*, published in Spanish and English and co-author of *Elementary Principles of Behavior*, second edition.



Kurt Salzinger (Hofstra University) has been Senior Scholar in Residence at Hofstra University in Hempstead, NY, since January 2003. He is author or editor of 12 books and over 120 articles and book chapters. The most recent book was edited by Rieber, R. W., and Salzinger in 1998: *Psychology: Theoretical-Historical Perspectives*. He has varied research interests, including behavior analysis applied to human beings, dogs, rats, and goldfish; schizophrenia; verbal behavior of children and adults; and history of psychology. Kurt has contributed tremendously by bringing behavior analysis to national and international attention as well as to that of the broader scientific community.



María Antonia Padilla Vargas (Universidad de Guadalajara) is a tenured professor at the University of Guadalajara, working at the Center for Behavioral Studies and Research. She is a member of National Researchers Association and founded in 2006 the Mexican Association for Psychological Research, over which she has presided ever since. She has published five books, 15 book chapters, and 26 research articles in indexed international journals on topics related to scientific practice, training new scientists, scientists interactions, and complex learning.

#### **Ad Hoc Committee Members**



Richard W. Malott (Western Michigan University, ABAI CE coordination for BACB certificants) has used the principles of behavior to construct teaching models and behavioral systems that have been sustained over several decades. As a result, he has provided the training grounds for many of the field's leaders in behavioral systems design. A prolific, creative, and engaging writer, he has authored some of the field's most important and widely read publications, including *Elementary Principles of Behavior* (first with Donald Whaley and then with Marie E. Malott and Elizabeth Trojan Suarez), which is in its sixth edition.



Marco Wilfredo Salas-Martínez (Universidad Veracruzana) is a professor with more than 60 research articles in psychology journals and national and international education, as well as five books and over 10 chapters on topics related to applied research to education. He currently serves as coordinator of the Master of Applied Research in Educational Psychology. His membership in professional organizations includes the Sociedad Mexicana de Análisis de la Conducta, the Mexican Society of Research in Psychology, National Network of Researchers in Educational Psychology, Multiregional Network of Quality Graduate Programs in Psychology, National College of Psychologists, and Red Multiregional Migration.

# Partnerships

We are proud to present the program for the Seventh International Conference—the first conference ABAI has held in Mexico. We are indebted to our partners who helped make this conference possible.

## University Partners



### Universidad de Guadalajara

The faculty at the Universidad de Guadalajara is renowned as one of the most important in Mexico. The university is a fundamental institution for the formation of high quality human resources and the production of scientific and technological knowledge that support the development of Jalisco. The cultural life and artistic wealth of Mexico's western region could not be accounted for without the pioneering and unique contribution of the Universidad de Guadalajara. Learn more at [www.udg.mx](http://www.udg.mx).

María Antonia Padilla Vargas served as the Universidad de Guadalajara representative during the organization of the conference program.

### Universidad Nacional Autónoma de México

The Universidad Nacional Autónoma de México (UNAM) was founded on September 21 in 1551 under the name Royal and Pontifical University of Mexico. It is the biggest university in Mexico and Ibero-America. The fundamental aim of UNAM is to serve both the country and humanity, train professionals, organize and carry out research—mainly on national problems and conditions, and offer cultural benefits in the broadest sense possible. Learn more at [www.unam.mx](http://www.unam.mx).

Javier Nieto Gutiérrez served as the UNAM representative during the organization of the conference program.

### Universidad Veracruzana

The Universidad Veracruzana began its formal existence on September 11, 1944. Its creation reflects the history of higher education in the state of Veracruz. Universidad Veracruzana has become the premier institution of higher learning in the state; what

started as a small group of schools and colleges is now a large and complex university with a presence in five university regions and 28 municipalities throughout the territory of Veracruz. Few universities in the country have experienced such important geographic deployment. Learn more at [www.uv.mx](http://www.uv.mx).

A. Daniel Gómez Fuentes and Wilfredo Salas served as the Universidad Veracruzana representatives during the organization of the conference program.

## Conference Planning and Assistance

We are proud to recognize the ABAI team, who has worked tirelessly behind the scenes to make this conference a reality. The ABAI staff includes Aaron Barsy, Elisabeth Berthiaume, Eric Bont, Nicole Casey, Lydia Cox, True Dwyer, Brandon Forth, Gary Hannah, Jean Herbrandson, Jack Lingbeek, Hadley Moore, Kelly Ohlert, Helen Pollard, Joseph Romeo, Majda Seuss, Eddie Soh, and Betty Soltesz.

## Other Acknowledgments

### Additional Thanks



ABAI would also like to thank Carlos Flores Aguirre and Cristiano Valerio from the University of Guadalajara for their help in organizing the Seventh International Conference in Mérida, Mexico.



### Special Thanks to the Sociedad Mexicana de Análisis de la Conducta

The Sociedad Mexicana de Análisis de la Conducta has represented behavior analysis in México for 35 years, publishes the *Mexican Journal of Behavior Analysis*, and holds an annual convention. Learn more at [www.smac.org.mx](http://www.smac.org.mx).

### Volunteers

Josue Gonzalez Diaz and Fanny Trujillo Martínez (Centro de Estudios e Investigaciones en Comportamiento, Universidad de Guadalajara); Gloria Teresa Tejeda Hernández, Delia de Jesús Domínguez Morales, María Lucía Pinto Portugal, and Katie Elizabeth Treu (Universidad Veracruzana); and Lía Cano Castellanos, Pedro Poot Matú, and José Luís Chi Zaldivar (Universidad Autónoma de Yucatán)

### Graphic Design

Martin Burch



## **ABAI Executive Council**

### **President (2012–2015)**

Michael Perone, Ph.D. (West Virginia University)

### **Past President (2011–2014)**

Kurt Salzinger, Ph.D. (Hofstra University)

### **President-Elect (2013–2016)**

Linda J. Parrott Hayes, Ph.D. (University of Nevada, Reno)

### **International Representative (2011–2014)**

Maria Martha Hübner, Ph.D. (Universidade de São Paulo)

### **At-Large Representative (2013–2016)**

Mark R. Dixon, Ph.D. (Southern Illinois University)

### **At-Large Representative (2012–2015)**

Travis Thompson, Ph.D. (University of Minnesota)

### **Applied Representative (2012–2015)**

SungWoo Kahng, Ph.D. (Kennedy Krieger Institute)

### **Experimental Representative (2011–2014)**

Raymond C. Pitts, Ph.D. (University of North Carolina Wilmington)

### **Past Student Representative (2011–2014)**

Megan D. Aclan, MS (Chicago School of Professional Psychology, Los Angeles)

### **Student Representative (2010–2013)**

Zachary Morford, MS (University of Nevada, Reno)

### **Student Representative-Elect (2011–2014)**

Jonathan E. Friedel, MS (Utah State University)

### **Chief Executive Officer**

Maria E. Malott, Ph.D. (Association for Behavior Analysis International)

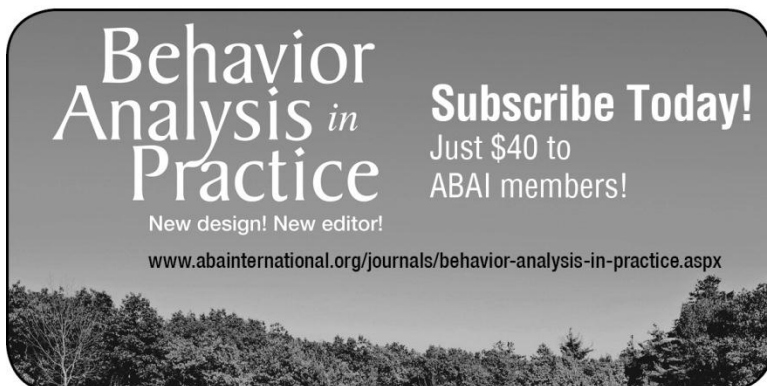

**Behavior  
Analysis *in*  
Practice**

New design! New editor!

**Subscribe Today!**  
Just \$40 to  
ABAI members!

[www.abainternational.org/journals/behavior-analysis-in-practice.aspx](http://www.abainternational.org/journals/behavior-analysis-in-practice.aspx)

# Registration and Continuing Education

## General Information

The registration desk is located on Floor 1 of the Hotel Fiesta Americana. Hours are as follows:

Sunday, October 6	2:00 pm–9: 00 pm
Monday, October 7	7:00 am–9: 00 pm
Tuesday, October 8	7:00 am–3: 30 pm

Badges are required for entrance to all conference events. Invited presentations will be in Yucatan II or Salon Mérida on Floor 2. A map is available on page 84.

## Continuing Education for Certified Behavior Analysts and Licensed Psychologists

ABAI is approved by the Behavior Analyst Certification Board (BACB) to offer type 2 continuing education (CE) to certified behavior analysts who have already passed their exam and have been issued a current and valid certification number and by the American Psychological Association (APA) to sponsor CE for licensed psychologists. ABAI maintains responsibility for its CE program and its content. To receive CE, attendees must:

- Pick up a CE sign-in and sign-out form from the CE desk.
- Attend the entire event.
- Sign in and out of the event with the ABAI staff members located near the door of the room. Staff members are unable to sign sheets for attendees entering over 5 minutes late or leaving more than 5 minutes early.
- Pay the credit fee of \$10 per credit.
- Provide a BACB certificant number (as relevant).

Continuing education certificates will be posted to attendees' portals upon receipt of payment.

Participants are encouraged to complete an event evaluation survey that will be emailed to registrants immediately following the conference.

Payment for CE may be made at the conference, through your ABAI portal account ([www.abainternational.org/portal](http://www.abainternational.org/portal)), or later via fax or mail. You may submit payment via fax or mail to:

Association for Behavior Analysis International  
550 W. Centre Ave., Suite 1  
Portage, Michigan 49024-5364 USA  
Fax: 001-269-492-9316

Please direct questions about CE to [mail@abainternational.org](mailto:mail@abainternational.org).

# About Poster Sessions

## Poster Session Schedule

Presenters may set up their posters in the Gran Salon Yucatan (Fiesta Americana) beginning at 6:30 pm on Monday evening. The first hour, posters with odd numbers will be discussed, and the second hour will be for posters with even numbers. This schedule allows presenters to view other posters. Posters will remain up for the entire session and must be removed immediately following the session.

## Categories of Poster Content

Presenters were asked to categorize their session as experimental analysis, applied behavior analysis, service delivery, or theory.

*Experimental Analysis* deals with representative response (can include verbal behavior in humans) in any species; theoretically driven, data-based activity carried out under auspices of research protocol; and anything with the ultimate function of disseminating artifacts (contingent on peer review) that contribute to generalizable knowledge about fundamental processes.

*Applied Behavior Analysis* deals with behavior selected on the basis of its social significance, human emphasis, intervention driven with cure orientation, data-based activity carried out under auspices of research protocol, development of new technology, and anything with the ultimate function of disseminating artifacts (contingent on peer review) that contribute to generalizable knowledge about how or why interventions, service delivery systems, or their components achieve desired goals. The function of any manipulation or analysis is to go beyond demonstrating that environmental manipulations will produce desired goals by identifying how or why interventions, service delivery systems, or their components achieve those goals.

*Service Delivery* deals with behavior selected on the basis of its social significance, human emphasis, intervention driven with cure orientation, frequently but not necessarily supported through fee for service arrangements and staff positions, extension of existing technology to new settings or populations, and is not predominantly undertaken to disseminate an artifact that contributes to generalizable knowledge, even though it may include data-based decision making. Presentations in this category are predominantly case histories, illustrations, descriptions, or demonstrations rather than analysis of how principles may be applied in interventions, service delivery systems, or their components to achieve desired goals. The function of any manipulation or analysis is to apply environmental manipulations to produce desired goals rather than to identify how or why interventions, service delivery systems, or their components achieve those goals.

*Theory* deals with abstract, conceptual, or integrative statements about organizations of facts, interpretations, or mathematical models and quantitative analyses. This area can also include historical and philosophical analyses or reviews.





**SEVENTH  
INTERNATIONAL  
CONFERENCE:** **MÉRIDA** MEXICO

**SUNDAY, OCTOBER 6**

**Schedule Overview  
Opening Reception**

Seventh International Conference; Sunday, October 06

Room	3 pm		4 pm		5 pm		6 pm		7 pm		8 pm		9 pm	
	:00	:30	:00	:30	:00	:30	:00	:30	:00	:30	:00	:30	:00	:30

Fiesta Americana Floor 2	Gran Sal3n Yucatan							Cash Bar Open	#1 Opening Reception						
	Yucatan I														
	Yucatan II														
	Yucatan III														
	Yucatan IV														
	Salon M3rida														
	Salon Celestun														
	Santa Lucia	Staff Office													
Valladolid	Speaker Ready Room		Press Conference		Speaker Ready Room										
Fiesta Americana Floor 1	Izamal														
Presidente Hotel	Gran Salon I														
	Gran Salon II														

**LEGEND**

-  = Special and Invited Events
-  = ABAI Services and staff rooms
-  = Food and Beverage

## # 1 Special Event

7:00 pm–9:00 pm

Gran Salon Yucatan (Fiesta Americana)

### Opening Reception

Chair: Martha Hübner (Universidade de São Paulo)

¡Bienvenidos! ABAI welcomes you to beautiful colonial Mérida, Mexico and ABAI's Seventh International Conference. Please join ABAI's presidents and the Conference Program Committee to celebrate the conference, the city, and the culture of Mexico with your colleagues from five continents. We especially welcome our collaborators from Universidad de Veracruz, Universidad Nacional Autónoma de México, and Universidad de Guadalajara. Mingle with us, partake of hors d'oeuvres and a cash bar, and enjoy a performance of local music and dance. We are so glad you can join us and look forward to seeing you.

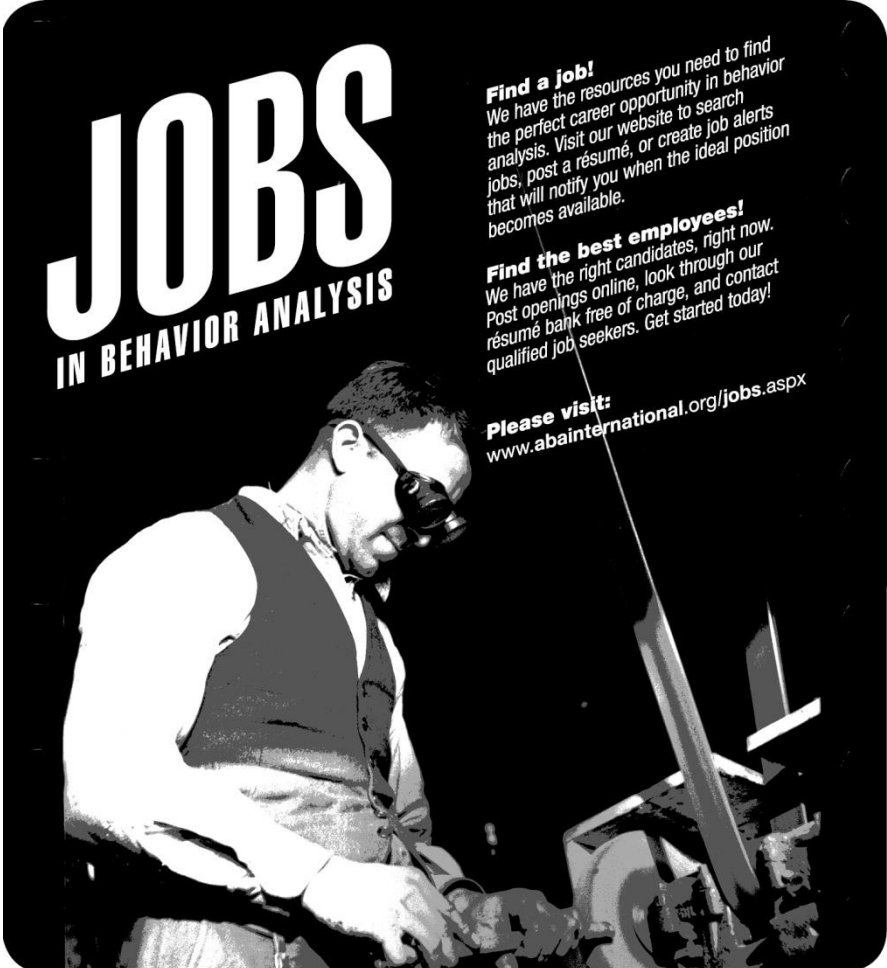

**JOBS**  
IN BEHAVIOR ANALYSIS

**Find a job!**  
We have the resources you need to find the perfect career opportunity in behavior analysis. Visit our website to search jobs, post a résumé, or create job alerts that will notify you when the ideal position becomes available.

**Find the best employees!**  
We have the right candidates, right now. Post openings online, look through our résumé bank free of charge, and contact qualified job seekers. Get started today!

**Please visit:**  
[www.abainternational.org/jobs.aspx](http://www.abainternational.org/jobs.aspx)







**SEVENTH  
INTERNATIONAL  
CONFERENCE:** **MÉRIDA** MEXICO  
**MONDAY, OCTOBER 7**

**Schedule Overview  
Invited and Breakout Sessions  
Poster Session**

Seventh International Conference; Monday, October 7

	Room	8 am		9 am		10 am		11 am		12 pm		1 pm		2 pm		
		:00	:30	:00	:30	:00	:30	:00	:30	:00	:30	:00	:30	:00	:30	
Fiesta Americana Floor 2	Gran Salon Yucatan															
	Yucatan I															
	Yucatan II		#2 EAB Bruner *†		#9 TPC Salzinger *†				#12 EAB De Rose *†		#19 VRB Greer *†		#26 CSE Mattaini *†			
	Yucatan III		#7 EAB Ch. De Rose			#11 TPC Ch. Bazán Canales <b>esp.</b>	Coffee Break	#15 EAB Ch. Torres <b>esp.</b>		#22 CSE Ch. Beirne *						
	Yucatan IV		#3 AUT Ch. Fleming-Holland					#18 TPC Ch. Crawford *		#23 EAB Ch. Stein						
	Salon Mérida		#8 OBM Ch. Ortega *					#17 OBM Ch. Candido		#20 AUT Ch. Richman *						
	Salon Celestun		#4 AUT Ch. Anderson			#10 OBM Ch. Yaber Oltra		#16 EAB Ch. Vaidya		#25 VRB Ch. Perez Almonacid <b>esp.</b>						
	Santa Lucia		Staff Office													
	Valladolid		Speaker Ready Room													
Fiesta Americana Floor 1	Izamal		#5 AUT Ch. Heilveil				Coffee Break	#13 AUT Ch. Park			#24 EAB Ch. Sharp					
Presidente Hotel	Gran Salon I														Lunch	
	Gran Salon II		#6 AUT Ch. Quiroga Anaya <b>esp.</b>				Coffee Break	#14 CBM Ch. Ballard			#21 CBM Ch. Barragan <b>esp.</b>					



## # 2 Invited Presenter

---

8:30 am–9:20 am

Yucatan II (Fiesta Americana)

EAB; Applied Behavior Analysis

PSY/BACB CE Offered. CE Instructor: Carlos A. Bruner, Ph.D.

### **Some Common Conditioning Variables Have an Effect on Eating by Rats**

Chair: Carlos Flores Aguirre (Universidad de Guadalajara)



CARLOS A. BRUNER (Universidad Nacional Autónoma de México)

Dr. Carlos A. Bruner completed his Ph.D. in 1981 at the Queens College of the City University of New York and has since been a professor at the Universidad Nacional Autónoma de México (UNAM). Dr. Bruner has published more than 130 journal articles and chapters in specialized

books on a wide range of topics in behavior analysis, including the influence of temporal context on the effects of delayed reinforcement on operant behavior and schedule-induced drinking. Dr. Bruner has contributed outstandingly to the development of behavior analysis in Mexico. He served twice as the president of the Mexican Society for Behavior Analysis and as editor of the *Mexican Journal of Behavior Analysis*. Dr. Bruner also has contributed to the growth of behavior analysis in Mexico through the mentorship of his students, many of whom now hold academic positions at universities in Mexico. During the last 15 years, he has held a distinguished National Researcher Award from the Mexican government and has been honored by UNAM with a PRIDE Award for academic excellence in teaching, research, and dissemination of knowledge.

**Abstract:** In the vast majority of operant experiments reinforcement magnitude (e.g., meal size) has been treated as a parameter of other independent variables that control the subject's behavior (e.g., the delivery of three food-pellets as reinforcement). By contrast, in some experiments conducted in our laboratory, we have focused on reinforcement magnitude (i.e., the number of response-produced food pellets) as the dependent variable of this type of experiment. In a first study, the rat's "natural" durations of an opportunity to eat and successive interopportunity periods were both altered. Shortening the feeding opportunities and lengthening the interopportunity periods increased the rate of eating. In a second study, the temporal location of a short neutral stimulus within the interopportunity period was varied. Food eaten was a decreasing function of lengthening the stimulus-opportunity interval, including either the enhancement or suppression of eating about a baseline with no stimulus. In a third experiment, the effects of reinforcement delay in a food-accumulation situation were studied. Food accumulation (and consumption) increased as delay of reinforcement was lengthened. The general conclusion of our experiments is that independent variables commonly studied in conditioning experiments have considerable influence on the magnitude of eating by rats.

### # 3 Paper Session

---

8:30 am–9:50 am

Yucatan IV (Fiesta Americana)

AUT

#### **Improving Abilities With Behavior Analysis**

Chair: Andree Fleming-Holland (Universidad Veracruzana)

**The Operant Conditioning of Letter String Problem Solving** (Experimental Analysis) MARCO PULIDO (Universidad Intercontinental)

**Implementation of a Program to Acquire Behavioral and Learning Skills in a Rural Mexican Middle School** (Applied Behavior Analysis) Cesar G. Aguilar-Salazar (Servicios Educativos Integrados al Estado de México) and ANDREE FLEMING-HOLLAND, Marco Wilfredo Salas-Martínez, and Esperanza Ferrant-Jimenez (Universidad Veracruzana)

**Positive Behavioral Supports in Community Based Settings With Individuals With Developmental Disabilities and Forensic Backgrounds** (Applied Behavior Analysis) ELIZABETH HUGHES (Institute for Applied Behavior Analysis)

### # 4 Paper Session

---

8:30 am–9:50 am

Salon Celestun (Fiesta Americana)

AUT

#### **Technological Tools for Working With Autism**

Chair: Angelika Anderson (Monash University)

**The Effects of a Wii Game Console on Engagement and Peer Interactions With Children With Autism Spectrum Disorder** (Service Delivery) KERRY HILLIER (University of Washington)

**Video-Modeling: Is It Modeling or Prompting or Priming?** (Applied Behavior Analysis) ANGELIKA ANDERSON and Dennis W. Moore (Monash University)

**Using the iPad or iPod Touch to Prompt and Develop Independent Communication in People With Autism While Reducing Frustration and Replacing Inappropriate Behaviour** (Applied Behavior Analysis) LISA DOMICAN (Grace App)

**Extending the Reach of ABA Practitioner Training: Innovations in Online Distance Education** (Service Delivery) RICHARD W. SERNA (University of Massachusetts, Lowell), Harold E. Lobo and Cindy K. Fleming (Praxis, Inc.), Richard K. Fleming (University of Massachusetts, Boston), Michelle M. Foran (University of Massachusetts, Lowell), Caroline Cooke (University of Southern California), and Charles Hamad (University of Massachusetts Medical School)

## # 5 Paper Session

---

8:30 am–9:50 am

Izamal (Fiesta Americana)

AUT

### Reviews and Criticism Related to Autism

Chair: Ira Heilveil (University of California, Los Angeles School of Medicine)

**The Business of Applied Behavior Analysis (Service Delivery)** IRA HEILVEIL (University of California, Los Angeles School of Medicine)

**Valuing Diversity: Just Because ABA Practitioners Can Change a Behavior of Autistic Individuals, Does Not Mean That We Should** (Applied Behavior Analysis) RHONDA J. GREENHAW (Towson University)

**Teaching Empathy Using Principles of Applied Behavior Analysis: A Meta-analytic Examination of Measurement and Results** (Applied Behavior Analysis) EMILY FALKENSTEIN (Ball State University)

## # 6 Paper Session

---

*Presented in Spanish*

8:30 am–9:50 am

Gran Salon II (Presidente Intercontinental)

AUT

### Analisis Conductual en la America Latina

Chair: Horacio Quiroga Anaya (Universidad Nacional Autónoma de México)

**A Stepped-Care Cognitive-Behavioral Motivational Model for College Students With Alcohol Problems** (Applied Behavior Analysis) HORACIO QUIROGA ANAYA and Tersita Cabrera Arteaga (Universidad Nacional Autónoma de México)

**The Reality of Working With Individuals With Autism in Peru Using an ABA Approach** (Applied Behavior Analysis) MAPY CHAVEZ CUETO, Patricia Martinelli Vargas, Graciela Caceres Agurto, Maria Belen Rodríguez Ferrari, and Jarume Angulo Noe (Alcanzando)

**Un Analisis de Contingencia de Tratamiento Para el Autismo en Mexico** (Applied Behavior Analysis) ALLEGRA MONTEMAYOR and Lee L. Mason (The University of Texas at San Antonio)

## # 7 Symposium

---

8:30 am–9:50 am

Yucatan III (Fiesta Americana)

EAB/VRB; Experimental Analysis

### Basic, Translational, and Theoretical Research on Stimulus Equivalence

Chair: Julio C. De Rose (Universidade Federal de São Carlos)

**The Functions of Meaningful Stimuli in Equivalence Class Formation** ERIK ARNTZEN (Oslo and Akershus University College), Richard Nartey (Akershus University College), and Lanny Fields (Queens College, City University of New York)

**Transfer of Meaning Between Equivalent Stimuli in Rearranged Classes** João Almeida and JULIO C. DE ROSE (Universidade Federal de São Carlos)

**Cochlear Implant Users Learn Auditory-Visual Conditional Discriminations and Include Sounds in Equivalence Classes With Pictures and Orofacial Cues** Sabrina Oliveira, Raquel Melo Golfeto, and DEISY DAS GARCAS DE SOUZA (Universidade Federal de São Carlos)

**An Integrated Theory of Relatedness Among the Stimuli in Equivalence Classes** LANNY FIELDS (Queens College, City University of New York), Erica Doran (The Graduate School of City University of New York), and Patricia A. Moss-Lourenco (Westchester Institute for Human Development)

## # 8 Panel Discussion

---

8:30 am–9:50 am

Salon Mérida (Fiesta Americana)

OBM; Service Delivery

BACB CE Offered. CE Instructor: Gia Vazquez Ortega, Psy.D.

**Strategies in Developing and Operating a Successful Applied Behavior Analysis Business for Individuals With Autism Spectrum Disorders: A Women's Perspective**

Chair: Gia Vazquez Ortega (Blossom Center for Children)

GIA VAZQUEZ ORTEGA (Blossom Center for Children)

JENNIFER CRAWFORD (The Learning Lane)

RANY THOMMEN (ABA Today)

REBECCA RYAN (Sandbox ABA)

## # 9 Invited Presenter

---

9:30 am–10:20 am

Yucatan II (Fiesta Americana)

TPC; Theory

PSY/BACB CE Offered. CE Instructor: Kurt Salzinger, Ph.D.

**Watson, Skinner, and the Science of Psychology**

Chair: Martha Hübner (Universidade de São Paulo)

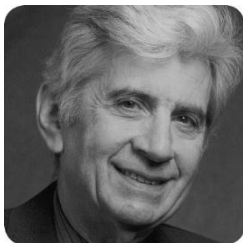

KURT SALZINGER (Hofstra University)

Kurt Salzinger, Ph.D., has been Senior Scholar in Residence at Hofstra University in Hempstead, NY, since January 2003. He was executive director for science at the APA from 2001–2003. He has been president of the New York Academy of Sciences, has served on the board of directors of the APA, and has been president of Divisions 1 (General

Psychology) and 25 (Behavior Analysis), and of the American Association of Applied and Preventive Psychology. He also served as the first chair of the board of the Cambridge Center 1986–1988, subsequently as a member until 1991, and again as a member of the board during 2004–2007. He is an author or editor of 12 books and more than 120 articles and book chapters. The most recent book he edited was with M. R. Serper in 2009, *Behavioral Mechanisms and Psychopathology* (Washington, DC: American Psychological Association). He has varied research interests, including behavior analysis applied to human beings, dogs, rats, and goldfish; schizophrenia; verbal behavior of children and adults; and history of psychology. He has both given grants (as a program officer at the National Science Foundation [NSF]) and received them for his own research (as a professor of psychology at Hofstra University and Polytechnic University of New York and principal research scientist at the New York State Psychiatric Institute). He received the Sustained Superior Performance Award from the NSF, the Stratton Award and the Presidential Award from the APA, the APA and the Most Meritorious Article Award from the *Journal of Behavior Therapy and Experimental Psychiatry*. In 2002, he was the presidential scholar at the ABAI annual convention. From 2009–2010, he was elected president of the Eastern Psychological Association. He served as president of ABAI in 2012.

**Abstract:** We do not risk damnation when we espouse behavior analysis, as Copernicus did when he removed humanity from the center of the world. Yet, many still characterize behavior analysis as too simple, too dangerous, and quite unacceptable. They reacted that way when Watson first espoused a behavioral approach 100 years ago, and they were not kinder to Skinner when he proposed a more all-encompassing approach to psychology while keeping true to the behavioral way. This paper will make an attempt to explain why behaviorism continues to elicit emotional responses from scientists and the public at large rather than the studied reaction that science is expected to elicit.

### **# 10 Paper Session**

---

10:00 am–10:20 am

Salon Celestun (Fiesta Americana)

OBM

### **Helping the Venezuelan Federation of Psychologists to Improve With Behavior Systems Analysis**

Chair: Guillermo E. Yaber Oltra (Universidad Simon Bolivar)

**Helping the Venezuelan Federation of Psychologists to Improve With Behavior Systems Analysis** (Service Delivery) GUILLERMO E. YABER OLTRA (Universidad Simon Bolivar)



## # 11 Paper Session

*Presented in Spanish*

---

10:00 am–10:20 am

Yucatan III (Fiesta Americana)

TPC

### **Philosophical History of Psychology**

Chair: Dulce M. Bazán Canales (Universidad Popular Autonoma De Veracruz)

**Philosophical History of Psychology (Theory)** DULCE M. BAZÁN CANALES  
(Universidad Popular Autonoma de Veracruz)

## # 12 Invited Presenter

---

11:00 am–11:50 am

Yucatan II (Fiesta Americana)

EAB; Service Delivery

PSY/BACB CE Offered. CE Instructor: Julio C. De Rose, Ph.D.

### **Stimulus Equivalence as a Model of Symbolic Behavior**

Chair: Martha Hübner (Universidade de São Paulo)



JULIO C. DE ROSE (Universidade Federal de São Carlos)

Julio de Rose obtained a doctoral degree at Universidade de São Paulo and has been a postdoctoral fellow at the Shriver Center for Mental Retardation. He is a professor of psychology at Universidade Federal de São Carlos, Brazil, and has published articles in the main behavioral journals, including the *Journal of the Experimental Analysis of Behavior*, *Journal of Applied Behavior Analysis*, *The Psychological Record*, and *The Analysis of Verbal Behavior*. He has served on the editorial board of *Journal of Applied Behavior Analysis*, currently serves on the editorial board of *The Psychological Record*, and is also co-editor of the Brazilian multidisciplinary journal *Olhar*.

**Abstract:** Several studies have confirmed that stimulus equivalence is a promising behavioral model of symbolic behavior. Behavioral, psychometric, and electrophysiological studies indicate that members of equivalence classes share meaning. Some of these studies formed equivalence classes comprising abstract and meaningful stimuli and showed that meaning transferred to the abstract stimuli. There are indications that this transfer varies quantitatively as a function of parameters such as nodal distance, amount of matching to sample training and matching delay. This has suggested that equivalent stimuli may vary in their degree of relatedness, which is incompatible with the very notion of equivalence. This presentation will discuss these strengths and threats involved in the notion of equivalence and eventual interpretative alternatives.

### # 13 Paper Session

---

11:00 am–12:20 pm

Izamal (Fiesta Americana)

AUT

#### **Enhancing Assessments for Individuals With ASD**

Chair: Hyun Ok Park (Baeksoek University)

**The Evolution of Applied Behavior Analysis in the Gulf Region** (Service Delivery) MONA AL HADDAD and Michelle Kelly (Dar AlHekma College) and Sharifa Yateem (New England Center for Children)

**A Review of the Single Subject Design Studies on the Social-Communication Interventions for Students With Autism Spectrum Disorder in Korea** (Theory) HYUN OK PARK (Baeksoek University)

**Enhancing Assessment for Individuals With ASDs: Opportunities for Collaboration Between Neuropsychology and Applied Behavior Analysis** (Theory) ROSEMARIE MANFREDI (Chestnut Hill College)

### # 14 Paper Session

---

11:00 am–12:20 pm

Gran Salon II (Presidente Intercontinental)

CBM

#### **Managing Self-Control, Bruxism, and Caregivers**

Chair: Linda Ballard (Special People in the Northeast)

**Use of Caregiver Reinforcer Survey and Stimulus Preference Assessment During Rehabilitation With Minimally Conscious Youth** (Applied Behavior Analysis) ADRIANNA M. AMARI, Valerie Paasch, and Keith J. Slifer (Kennedy Krieger Institute)

**Beyond the Daily Grind: Towards an Evolutionary Behavioral Approach to Bruxism** (Theory) LINDA BALLARD (St. Joseph's University) and Donald A. Hantula (Temple University)

**ABA and the Self Control of Excessive Caloric Intake Using an iPhone App** (Applied Behavior Analysis) GARY W. LAVIGNA (Institute for Applied Behavior Analysis)

### # 15 Symposium

---

*Presented in Spanish*

11:00 am–12:20 pm

Yucatan III (Fiesta Americana)

EAB/TPC; Experimental Analysis

#### **Propuestas Metodologicas Para el Analisis del Ajuste Diferencial y Efectivo Empleando Programas Definidos Temporalmente**

Chair: Carlos Torres (Universidad de Guadalajara)

Discussant: Mario Serrano (Universidad Veracruzana)

**Efectos de la Duración del Intervalo Entre Estímulos Sobre el Ajuste Efectivo**

CARLOS FLORES AGUIRRE, Carlos Torres, and Gabriel Velázquez González  
(Universidad de Guadalajara)

**Evaluación del Ajuste Diferencial: Explorando los Efectos del Espaciamiento**

**Entre Estímulos Contextualizadores** MARIO SERRANO, Carlos Torres, Gabriel Velázquez González, Carlos Flores Aguirre (Universidad de Guadalajara)

**Efectos de Distintos Tipos de Moldeamiento del Segmento de Respuesta en**

**el Ajuste Efectivo en Ratas** CARLOS TORRES, Carlos Flores Aguirre, and Ivan Gómez (Universidad de Guadalajara)

**# 16 Symposium**

---

11:00 am–12:20 pm

Salon Celestun (Fiesta Americana)

EAB/TPC; Experimental Analysis

**Recent Developments in the Study of Associative Symmetry in Nonhumans**

Chair: Manish Vaidya (University of North Texas)

**Stimulus Control in a Go/No-Go Procedure With Compound Stimuli With Pigeons**

HELOISA CURSI CAMPOS and Paula Debert (Universidade de São Paulo)

**Emergent Symmetry in Pigeons' Go/No-Go Performance: The Role of**

**Stimulus Control Topography Coherence** MANISH VAIDYA and Jay Hinnenkamp (University of North Texas)

**A Search for Emergent Same-Different and Symmetry Relations in Rats**

MARK GALIZIO, Ashley Prichard, and Katherine Ely Bruce (University of North Carolina Wilmington)

**Associative Symmetry After Arbitrary and Dual-Oddity Successive Matching**

**Training in Pigeons** PETER URCUIOLI (Purdue University), Heloisa Cursi Campos (Universidade de São Paulo), and Melissa J. Swisher (Purdue University)

**# 17 Panel Discussion**

---

11:00 am–12:20 pm

Salon Mérida (Fiesta Americana)

OBM; Theory

**Role of Leadership in Cultural Change**

Chair: Amber Marie Candido (University of Nevada, Reno)

MARK P. ALAVOSIUS (University of Nevada, Reno)

SIGRID S. GLENN (University of North Texas)

RAMONA HOUMANFAR (University of Nevada, Reno)

MARIA E. MALOTT (Association for Behavior Analysis International)

## # 18 Symposium

---

11:00 am–12:20 pm

Yucatan IV (Fiesta Americana)

TPC/EDC; Applied Behavior Analysis

BACB CE Offered. CE Instructor: Jennifer Crawford, M.Ed.

### **The Foundations of ABA: Is It a Myth or a Method? A Review of Emerging and Established Treatments for the Autism Population**

Chair: Jennifer Crawford (The Learning Lane)

**Established Treatments: A Brief Literature Review According to the National Standards Report on Autism Spectrum Disorders** JENNIFER CRAWFORD (The Learning Lane)

**The Foundations of Motivation in Applied Behavior Analysis** GIA VAZQUEZ ORTEGA (Blossom Center for Children)

**The Foundations of Rule-Governed Behavior in Applied Behavior Analysis** RANY THOMMEN (ABA Today)

**The Foundations of Replacement Behavior in Applied Behavior Analysis** REBECCA RYAN (Sandbox ABA)

## # 19 Invited Presenter

---

12:00 pm–12:50 pm

Yucatan II (Fiesta Americana)

VRB; Applied Behavior Analysis

PSY/BACB CE Offered. CE Instructor: R. Douglas Greer, Ph.D.

### **The Identification and Induction of the Social Reinforcers for Language Functions**

Chair: Martha Hübner (Universidade de São Paulo)

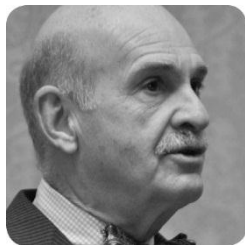

R. DOUGLAS GREER (Columbia University Teachers College and Graduate School of Arts and Sciences)

Dr. R. Douglas Greer is the coordinator of the programs in applied behavior analysis at Teachers College at Columbia University. He has taught at Columbia University Teachers College and the Graduate School of the Arts and Sciences for 42 years, sponsored 170 Ph.D. dissertations, taught more than 2,000 master students, founded the Fred S. Keller School, authored 13 books and 155 research and conceptual papers, served on the editorial board of 10 journals, and developed the CABAS' school model for special education and the Accelerated Independent Model for general education (K-5). He has received the APA's Fred S. Keller Award for Distinguished Contributions to Education, the ABAI Award for International Dissemination of Behavior Analysis, been honored for his contributions to The Fred S. Keller School, and May 5 has been designated as the R. Douglas Greer Day by the Westchester County Legislature. He is a Fellow of the ABAI and a CABAS board-certified senior behavior analyst and senior research scientist. He has taught courses at the universities of Almeria, Grenada, Cadiz, Madrid, Oviedo, and Salamanca in Spain; Oslo and Askerhus College in Norway;

University of Ibadan in Nigeria; and University of Wales at Bangor in England. Dr. Greer has served as the keynote speaker at the Experimental Analysis of Behavior Group in England; the National Conferences on Behavior Analysis in Ireland, Israel, Korea, Norway; and several conferences in several states in the United States. He contributed to the development of several schools based entirely on scientific procedures and comprehensive curriculum based assessment in the USA, Ireland, Sicily, England, and Spain. He is co-author of the book *Verbal Behavior Analysis: Developing and Expanding Verbal Capabilities in Children With Language Delays*.

**Abstract:** We have a greater understanding of the experiential sources for the social and language deficits in children with autism. Moreover, we know more about what to do to improve their social and verbal prognosis. These advances in the science of behavior are based on converging basic and applied research findings on (a) emergent behavior (i.e., learned responses that emerge indirectly from directly teaching other operants or respondents), (b) verbal behavior and verbal behavior development, and (c) applications in schools with more than 300 children. One set of findings concerns how a single stimulus comes to control different verbal behaviors and how a single response comes to be useful for different functions. Still others show how children come to learn language incidentally (i.e., without direct or indirect instruction). Other findings identify the role of conditioned reinforcement underlying language as a social tool and social reinforcer. These findings, and extensive replications with children, provide new and advanced expertise to bring children's verbal behavior under the natural reinforcers for language functions. The reinforcers for verbal behavior are the keys to what makes language social, and vice-versa—these reinforcers are learned. We have identified many key learned reinforcers and how they are learned incidentally. Better yet, we now have protocols to condition them if they are missing in a child's reinforcement repertoire. True verbal and social behaviors accrue from changes in reinforcers for language.

## # 20 Symposium

---

12:30 pm–1:50 pm

Salon Mérida (Fiesta Americana)

AUT/EAB; Applied Behavior Analysis

BACB CE Offered. CE Instructor: Iser Guillermo DeLeon, Ph.D.

### **Approach, Avoidance, and Autism**

Chair: David M. Richman (Texas Tech University)

Discussant: Ethan S. Long (Virginia Institute of Autism)

**Anxiety in Individuals With Autism** LOUIS P. HAGOPIAN (Kennedy Krieger Institute)

**Contrasting Neuroimaging Patterns in Two Individuals With Autism**

**Spectrum Disorder and Specific Phobia** DAVID M. RICHMAN, Wesley H.

Dotson, Mary J. Baker, Michael O'Boyle, and Kushal Kapse (Texas Tech

University); Amanda Bosch (Sam Houston State University); and Dan Fang and

Justin Brough (Texas Tech University)

**The Relative Value of Isolate and Mother-Child Play in Children With Autism: A Behavioral Economic Analysis** ISER GUILLERMO DELEON, Melissa Goldberg, Melissa J. Allman, Michelle A. Frank-Crawford, and Louis P. Hagopian (Kennedy Krieger Institute)

**# 21 Paper Session**

*Presented in Spanish*

---

12:30 pm–1:50 pm

Gran Salon II (Presidente Intercontinental)

CBM

**Bullying y Dependencia a Sustancias Adictivas: Desafíos Para la Analisis Conductual**

Chair: Lydia Barragan (Universidad Nacional Autónoma de México)

**Intervención a Familiares y Otros Significativos de Usuarios con Dependencia a Sustancias Adictivas** (Applied Behavior Analysis) LYDIA BARRAGAN, Araceli Flores Angeles, Nara Gabriela Pérez Mercado, and Silvia Morales (Universidad Nacional Autónoma de México)

**Teorías de la Coercion y Del Control Del Recurso, su Potencialidad Para Explicar el Bullying** (Applied Behavior Analysis) ANA DEL R. CERVANTES-HERRERA and Francisco J. Pedroza-Cabrera (Universidad Autónoma de Aguascalientes)

**Conductas Referidas Como Bullying, Agresion y Molestar por Adolescentes de Secundaria: Implicaciones Para su Abordaje** (Applied Behavior Analysis) SAN JUANA AGUILERA RUBALCAVA and Francisco J Pedroza-Cabrera (Universidad Autónoma de Aguascalientes)

**# 22 Symposium**

---

12:30 pm–1:50 pm

Yucatan III (Fiesta Americana)

CSE/AUT; Applied Behavior Analysis

BACB CE Offered. CE Instructor: Ann B. Beirne, M.A.

**International Service Delivery: Views From Both Sides**

Chair and Discussant: Ann B. Beirne (Global Autism Project)

**Bienvenidos: Working in Lima** PATRICIA MARTINELLI VARGAS (Alcanzando)

**The Traveling Behavior Analyst: Meeting the Challenge of International Work** ANN B. BEIRNE (Global Autism Project)

**International Training Models** MOLLY OLA PINNEY (Global Autism Project)

## # 23 Symposium

---

12:30 pm–1:50 pm

Yucatan IV (Fiesta Americana)

EAB/BPH; Experimental Analysis

### **Delay Discounting in the Human and Nonhuman Laboratories: Effects of History, Drug Administration, and Commodity Type**

Chair: Jeffrey S. Stein (Utah State University)

**Impulsive Choice, Alcohol Consumption, and Prolonged Pre-exposure to Delayed Reinforcement in Rats** JEFFREY S. STEIN, Renee Renda, Shayne Barker, Kennan J. Liston, and Gregory J. Madden (Utah State University)

**Differential Rearing Effects on Impulsivity** KIMBERLY KIRKPATRICK and Andrew Marshall (Kansas State University)

**Effects of Oral Methamphetamine on Discounting of Delayed Monetary and Sexual Outcomes in Stimulant Users** PATRICK S. JOHNSON, Natalie Rose Bruner, and Matthew W. Johnson (Johns Hopkins University School of Medicine)

**Cross-Commodity Discounting of Cocaine and Money in Cocaine Users and Community Controls** MIKHAIL KOFFARNUS (Virginia Tech Carilion Research Institute), Terry M. Lorenz, Michael J. Wesley, P. Read Montague, and Warren K. Bickel (Virginia Tech Carilion Research Institute)

## # 24 Paper Session

---

12:30 pm–1:50 pm

Izamal (Fiesta Americana)

EAB

### **Methodological Discussions and Directions**

Chair: Rebecca A. Sharp (University of Auckland)

**Using Calibration and Interobserver Agreement to Assess the Need for Training Novice Observers** (Applied Behavior Analysis) KATRINA J. PHILLIPS, Oliver C. Mudford, and Douglas Elliffe (University of Auckland)

**How Representativeness is Affected by Dimensions of Behavior and Sampling Methods** (Applied Behavior Analysis) REBECCA A. SHARP, Oliver C. Mudford, and Douglas Elliffe (University of Auckland)

**Effectively Translating Indirect Assessments With an Eye Toward Reliability and Validity** (Applied Behavior Analysis) CRISTINA VEGA (Foothill Child Development Services Inc.), Michele D. Wallace (California State University, Los Angeles), and Marisela Alvarado and Adriana Gracias (Foothill Child Development Services Inc.)

**Low-Cost Portable Device for Collecting Behavioral Data Based on the Arduino Board** (Applied Behavior Analysis) CARLOS ALEXIS PÉREZ HERRERA and Rogelio Escobar (Universidad Nacional Autónoma de México)

## # 25 Symposium

*Presented in Spanish*

---

12:30 pm–1:50 pm

Salon Celestun (Fiesta Americana)

VRB/EAB; Experimental Analysis

### **Conceptos, Abstraccion, y Lenguaje**

Chair: Ricardo Pérez Almonacid (Universidad Veracruzana)

Discussant: Telmo Eduardo Peña Correal (Universidad del Rosario)

**Efectos de Diversos Aspectos de la Retroalimentacion Asociada con la Produccion de Instrucciones en Tareas de Discriminacion Condicional de Segundo Orden** LUIS RENÉ BAUTISTA CASTRO (Universidad Veracruzana)

**Discrepancia en la Categorizacion de Dos Colecciones de Objetos en Nios** SOFIA GURI HERNÁNDEZ TORRES and Edgar Eduardo Montes Castro (Universidad de Guadalajara)

**Complejidad Conceptual y Tipos de Interaccion Linguistica** RICARDO PÉREZ ALMONACID, Margareth Melina Rangel Cárdenas, and Jannay Herguz (Universidad Veracruzana)

## # 26 Invited Presenter

---

1:00 pm–1:50 pm

Yucatan II (Fiesta Americana)

CSE; Service Delivery

PSY/BACB CE Offered. CE Instructor: Mark A. Mattaini, DSW

### **Behavioral Systems Science for Constructing Peaceful Communities**

Chair: Marco Wilfredo Salas-Martinez (Universidad de Veracruzana)



MARK A. MATTAINI (Jane Addams College of Social Work, University of Illinois at Chicago)

Mark Mattaini, DSW, is an associate professor at the Jane Addams College of Social Work at the University of Illinois at Chicago. Editor of the journal *Behavior and Social Issues*, Dr. Mattaini is also the author/editor of 10 books, including *PEACE POWER for Adolescents: Strategies for a Culture of Nonviolence* (NASW Press), and *Finding Solutions to Social Problems: Behavioral Strategies for Change* (American Psychological Association, with Bruce Thyer), and more than 80 other publications. Since the mid-1990s, Dr. Mattaini has focused his research and practice on behavioral systems analysis for violence prevention with youth, and analyses of the dynamics of nonviolent struggle. His new book, *Strategic Nonviolent Power: The Science of Satyagraha*, published by Athabasca University Press and available in open access format online, analyzes potential contributions of behavioral systems science to nonviolent social action and civil resistance supporting justice and human rights. He also is consulting with the American Friends Service Committee on peace-building projects.



**Abstract:** This presentation suggests that Israel Goldiamond's constructional approach can contribute to improvements in behavioral systems with profound social impact. The emphasis will be on contributions constructional behavioral systems analysis (BSA) can bring to understanding the dynamics of violence and to supporting human rights through the construction of peaceful communities and social structures. (Similar analyses may be valuable in areas like achieving sustainable lifestyles, or constructing effective justice and policing systems.) Examples analyzed for current or potential contributions from constructional BSA will include initiating and sustaining cultures of recognition and respect in schools; community action to construct peaceful neighborhoods in Chicago, IL, and North Charleston, SC; construction of cross-national cultures of youth activism for peace with the American Friends Service Committee; implementation of communitarian policing in Colombia; and sustainment of unity and nonviolent discipline in self-liberation movements globally. Some of these examples have explicitly incorporated BSA; others are well enough documented those probable systems dynamics can be extracted for further rigorous exploration. Both successes and struggles offer data that can contribute to our understanding of BSA, and crucially to campaigns for liberation from violence. Analytic tools from the author's recent book, *Strategic Nonviolent Power*, will be used throughout.

## # 27 Symposium

*Presented in Spanish*

---

4:00 pm–5:20 pm

Izamal (Fiesta Americana)

CBM/PRA; Applied Behavior Analysis

### **Functional Analytic Psychotherapy: Using Methodology From Behavior Analysis to Clinical Issues**

Chair: Amanda Munoz-Martínez (Fundación Universitaria Konrad Lorenz)

**Training Coders in FAP: How It Makes Functional Descriptive Analysis of Therapeutic Sessions?** ERIKA NIÑO (Pontificia Universidad Javeriana)

**The Assessment and Measurement in Clinical Practice of Functional Analytic Psychotherapy** CATALINA VELANDIA ALARCÓN (Pontificia Universidad Javeriana)

**PAF Intervention Based on Descriptive Functional Analysis in Session** NATALIA ESPARZA LIZARAZO (Pontificia Universidad Javeriana)

**Using Descriptive Functional Analysis in Translational Research in FAP** AMANDA MUNOZ-MARTINEZ (Fundación Universitaria Konrad Lorenz)

## # 28 Symposium

4:00 pm–5:20 pm

Yucatan III (Fiesta Americana)

EAB/VRB; Experimental Analysis

### **Basic and Translational Studies on Reading Acquisition**

Chair: Deisy das Graças De Souza (Universidade Federal de São Carlos)

Discussant: William J. McIlvane (University of Massachusetts Medical School)

**Some Determinants of Musical Score Reading: Finding Similarities and Differences With Textual Reading** ELENICE SEIXAS HANNA (Universidade de Brasília) and Erik R. Huber (Universidade Católica de Goiás)

**Multiple Exemplar Instruction Produces Generalized Reading of Complex Textual Units** Viviane Verdu Rico (Universidade Federal de Minas Gerais) and JULIO C. DE ROSE (Universidade Federal de São Carlos)

**Reading and Writing Whole Words, Derived From Matching-to-Sample Training, as a Function of the Baseline Training** Thaize Reis and DEISY DAS GRAÇAS DE SOUZA (Universidade Federal de São Carlos)

---

**# 29 Symposium**

*Presented in Spanish*

4:00 pm–5:20 pm

Gran Salon II (Presidente Intercontinental)

EAB/CBM; Applied Behavior Analysis

**Analysis and Treatment of Behavioral Problems and Impulsivity**

Chair: Ariel Vite Sierra (Universidad Nacional de Mexico)

Discussant: David Miranda (Universidad Autonoma del Estado de Mexico)

**The Instructions as Moderator Between Maternal Responsiveness and Behavioral Problems** ARIEL VITE SIERRA, Dayanth Pérez, and Javier Alfaro (Universidad Nacional Autónoma de México)

**The Role of Positive Parenting Practices in Child Emotion Regulation** MARIANA BARBA and Ariel Vite Sierra (Universidad Nacional Autónoma de México)

**Development of Self-Control in Children With Behavior Problems and Impulsivity** LETICIA CAPORAL, Alejandra Moysén, and Ariel Vite Sierra (Universidad Nacional Autónoma de México)

---

**# 30 Symposium**

4:00 pm–5:20 pm

Salon Mérida (Fiesta Americana)

EAB/TPC; Experimental Analysis

**Gambling SIG: Recent Developments in the Analysis of Gambling Behavior**

Chair and Discussant: Andrew E. Brandt (Ohio Wesleyan University)

**Development of a Valid Game-Credits Market in Laboratory-Simulated Gambling** ANDREW E. BRANDT and Jessica Martin (Ohio Wesleyan University)

**Dynamics of Risky Choice: Effects of Wins, Losses, and Amount of Exposure to the Balloon Analogue Risk Task** ELIAS (BART) ROBLES (Arizona State University)

**Testing the GFA-R in a Nationwide Sample** JEFFREY N. WEATHERLY (University of North Dakota)

## # 31 Symposium

*Presented in Spanish*

---

4:00 pm–5:20 pm

Yucatan IV (Fiesta Americana)

EAB; Experimental Analysis

### **Mexican Network for Research on Animal Behavior I**

Chair: Mario Serrano (Universidad Veracruzana)

**Parametric Research on Choice and Decision Making Behavior: Two Examples** RAUL AVILA (Universidad Nacional Autónoma de México)

**Methodology for the Study of the Organism's Adjustment to Environmental Changes** GERARDO ORTIZ, José Claudio Partida Martínez, Olivia Nuñez, and María José López (Universidad de Guadalajara)

**Effective Adjustment of Temporal Interactions** CARLOS TORRES (Universidade Guadalajara)

**Different Levels of Behavioral Adjustment** MARIO SERRANO (Universidad Veracruzana)

## # 32 Invited Symposium

---

4:00 pm–5:20 pm

Yucatan II (Fiesta Americana)

TPC

PSY/BACB CE Offered. CE Instructor: João Claudio Todorov, Ph.D.

### **Cultural Practices in Behavior Analysis**

Chair: M. Jackson Marr (Georgia Tech)

Discussant: João Claudio Todorov (Universidade de Brasília)

### **Cultural Practices and Contingencies of Selection**

SIGRID S. GLENN (University of North Texas)



Sigrid S. Glenn, Regents Professor Emeritus at the University of North Texas (UNT), was the founding chair of its Department of Behavior Analysis and the primary author of UNT's ABAI-accredited master's program, as well as the nation's first bachelor's degree program in applied behavior analysis. She is a past president of ABAI and was chosen as one of the association's five founding fellows. Dr. Glenn's published work includes empirical and theoretical articles, as

well as books and book chapters, targeting audiences within and outside behavior analysis. She travels nationally and internationally, lecturing on behavior theory and philosophy and cultural processes from a behavior analytic world view.

**Abstract:** Behavior analysts generally recognize that the operation of behavioral principles in the everyday world is constrained by the biology of behaving organisms and, in the case of humans, by the particulars of the cultural

environment in which behavior occurs. In this paper, we distinguish between process and content in behavioral and cultural domains. We explore the constraints on behavior imposed by culture, conceived here as that part of the environment constructed by multiple people over extended time periods. It is suggested that "cultural practices" is not a technical term in a behavior analytic analysis of cultures, but rather is an everyday term used for a multiplicity of phenomena. The phenomena commonly called "cultural practices" are examined as products of various combinations of behavioral and cultural level contingencies of selection.

### **Behavioral Systems as Metacontingencies**

INGUNN SANDAKER (Oslo and Akershus University College)



Dr. Ingunn Sandaker is a professor and program director of the Master and Research Program Learning in Complex Systems at Oslo and Akershus University College. She also initiated the development of the first the Ph.D. program in behavior analysis in Norway. She has been the program director since it was established in 2010. She received her Ph.D. in 1997 at the University of Oslo with a grant from the Foundation for Research in Business and Society at the

Norwegian School of Economics and Business Administration. Her thesis was a study on the systemic approach to major changes in two large companies: one pharmaceutical company and one gas and petroleum company. During preparations for the Olympic Games in Sydney, Australia, and Nagano, Japan, she headed the evaluation of a program aimed at extending female participation in management and coaching and assisting the Norwegian Olympic Committee's preparations for the games. For a number of years, Dr. Sandaker worked as an adviser on management training and performance in STATOIL and Phillips Petroleum Co. in Norway. She also was project manager for Railo International who, in cooperation with the Norwegian School of Economics and Business Administration, ran a project preparing the electricity supply system in Norway for marked deregulations. Serving as a consultant on top level management programs in Norwegian energy companies, her interest has been focused on performance management within a systems framework. Trying to combine the approaches from micro-level behavior analysis with the perspective of learning in complex systems and cultural phenomena, she is interested in integrating complementary scientific positions with the behavior analytic conceptual framework.

**Abstract:** In contrast to many social sciences, behavior analysis offers a technical conceptual framework that is generic in the sense that it is valid in different contexts and for a variety of organisms. The selectionist perspective adds value to the analysis of behavior at different levels of complexity. The systems' perspective extends the scale and scope for behavior analysis to explain such phenomena as emergent behavior, self-organizing behavioral systems, and the consequences of cultural cusps. The complex (functional) relations between behaviors and systems contingencies might be relevant when exploring both cultural selection and the selection of cultures.

## Cultural Systems Analysis and Collective Violence

MARK A. MATTAINI (Jane Addams College of Social Work at the University of Illinois at Chicago)



Mark Mattaini, DSW, is an associate professor at the Jane Addams College of Social Work at the University of Illinois at Chicago. Editor of the journal *Behavior and Social Issues*, Dr. Mattaini is also the author/editor of 10 books, including *PEACE POWER for Adolescents: Strategies for a Culture of Nonviolence* (NASW Press), and *Finding Solutions to Social Problems: Behavioral Strategies for Change* (American Psychological Association, with Bruce

Thyer), and more than 80 other publications. Since the mid-1990s, Dr. Mattaini has focused his research and practice on behavioral systems analysis for violence prevention with youth, and analyses of the dynamics of nonviolent struggle. His new book, *Strategic Nonviolent Power: The Science of Satyagraha*, published by Athabasca University Press and available in open access format online, analyzes potential contributions of behavioral systems science to nonviolent social action and civil resistance supporting justice and human rights. He also is consulting with the American Friends Service Committee on peace-building projects.

**Abstract:** Collective violence (war, terrorism, violent political conflicts, genocide, repression, organized criminal activity, disappearances, torture, and a range of other abuses of human rights) killed at least 200 million people, and injured an incalculable number more during the 20th century. The problem clearly continues into the present in many parts of the world, and offers a rich field for exploring the dynamics of cultural systems. This paper explores the roots of such violence from the perspective of the natural science of behavior, which in combination with historical observation at least suggests potential approaches for understanding and challenging patterns of violence perpetrated among interlocking cultural entities and populations. Examples explored here will be drawn from post-colonial states, in which the dynamics of collective violence can be particularly challenging. The analyses that will be presented suggest that policy makers and communities often rely on politically manipulated strategies that are inherently weak or counterproductive. Constructional options (as sketched here and developed in detail in the author's recent book *Strategic Nonviolent Power*) offer alternatives drawing on recent advances in the selectionist analysis of cultural practices, networks of interlocking behavioral contingencies, and metacontingencies within behavioral systems. Behavioral systems/cultural analysts face enormous challenges and opportunities in this work, meriting the commitment of substantial scientific resources.

### # 33 Symposium

*Presented in Spanish*

---

4:00 pm–5:20 pm

Salon Celestun (Fiesta Americana)

VRB/EAB; Experimental Analysis

#### **Lenguaje y Contingencias Conductuales**

Chair: Lizbeth Pulido Avalos (Universidad Veracruzana)

Discussant: Telmo Eduardo Peña Correal (Universidad del Rosario)

**Efecto del Tipo de Contingencia en el Establecimiento y la Calidad de Intercambios Verbales** LIZBETH PULIDO AVALOS (Universidad Veracruzana) and Nora Rangel and Gerardo A. Ortíz Rueda (Universidad de Guadalajara)

**Una Propuesta Conceptual y Metodologica para Analizar el Desarrollo de Competencias Linguisticas** ENOC OBED DE LA SANCHA VILLA (Universidad Veracruzana)

**La Explicitacion Linguistica y la Transformacion de Contingencias** EMANUEL MERAZ MEZA (Universidad Veracruzana)

### # 34 Invited Presenter

---

5:30 pm–6:20 pm

Salon Mérida (Fiesta Americana)

EDC; Experimental Analysis

PSY/BACB CE Offered. CE Instructor: Lanny Fields, Ph.D.

#### **Teaching Writing Without Writing: A Joint Stimulus Control Analysis**

Chair: Deisy das Graças De Souza (Universidade Federal de São Carlos)

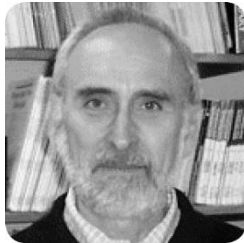

LANNY FIELDS (Queens College, City University of New York) and Jack Spear and Joshua Cooper (The Graduate School of City University of New York)

Dr. Lanny Fields received his Ph.D. from Columbia University in 1968. He is a psychology professor at Queens College, City University of New York. Dr. Fields is a member of the APA: Fellow, Divisions 2, 6, and 25; The Psychonomic Society; Sigma Xi; the American Psychological Society; the Cambridge Center for Behavioral Studies; and the Eastern Psychological Association. He has served on the editorial boards of the *European Journal of Behavior Analysis*, *Journal of the Experimental Analysis of Behavior*, and *The Psychological Record*. His research interests include variables that induce the formation of conceptual classes and enhance the ability to categorize and classify information as well as the neural substrates of concept formation.

**Abstract:** Typically, undergraduate psychology majors have difficulties writing complete and accurate descriptions of information presented in graphs that depict the interactive effects of two variables on behavior. Training visual-visual conditional discriminations between graphs and written descriptions did not

improve the written descriptions of graphs. The graphs and corresponding textual descriptions have many elements that must be attended to if they are to influence writing behavior. Traditional conditional discrimination training does not require attention to all of those pictorial and textual elements. Training of conditional discriminations designed to ensure attention to all features of the graphs and printed text resulted in dramatic improvements in the written descriptions of these complex graphs. The establishment of joint stimulus control by all elements of graphs and their corresponding printed texts (a selection-based repertoire) induced accurate written descriptions of complex graphs (a production-based repertoire). Thus, students learned to write without writing.

### **# 35 Symposium**

*Presented in Spanish*

---

5:30 pm–6:50 pm

Salon Celestun (Fiesta Americana)

CBM/EDC; Applied Behavior Analysis

#### **Applied Behavior Analysis in the 21st Century: Building Capacity in Schools, Healthcare, and Behavioral Pediatrics**

Chair and Discussant: Ethan S. Long (Virginia Institute of Autism)

##### **Behavioral Pediatrics: Applications of ABA in Pediatric Medical Centers**

ALISA BAHL (University of Virginia)

##### **Using Behavior Analysis to Facilitate Recovery of Post-concussion**

**Syndrome** WILLIAM J. WARZAK and Silvina Salvi (University of Nebraska Medical Center), Sela Ann Sanberg (University of Nebraska Medical Center; California), Louis Morales Knight (Boys Town), and Brigid Vilardo (University of Nebraska Medical Center)

##### **Supporting Children With Challenging Behavior in Schools: Building Capacity via Behavior Analysis**

CYNTHIA ANDERSON (Appalachian State University)

### **# 36 Symposium**

---

5:30 pm–6:50 pm

Gran Salon II (Presidente Intercontinental)

EAB/VRB; Experimental Analysis

#### **Some New Findings Within Research on Equivalence Class Formation**

Chair: Erik Arntzen (Oslo and Akershus University College)

##### **Extended Testing and Delayed Emergence of Derived Relations**

TORUNN LIAN and Erik Arntzen (Oslo and Akershus University College)

##### **Talk-Aloud Protocol in Delayed Matching-to-Sample**

ALEKSANDER VIE and Erik Arntzen (Oslo and Akershus University College)

##### **Titration of DMTS to Asymptotic Level in Adult Participants**

HANNA STEINUNN STEINGRIMSDOTTIR and Erik Arntzen (Oslo and Akershus University College)

**Using Eye-Tracking Technology to Study Observing Behavior During Conditional Discrimination Training With Different Training Structures** STEFFEN HANSEN and Erik Arntzen (Oslo and Akershus University College)

**# 37 Symposium**

*Presented in Spanish*

---

5:30 pm–6:50 pm

Izamal (Fiesta Americana)

VRB/EAB; Experimental Analysis

BACB CE Offered. CE Instructor: Mapy Chavez Cueto, Ph.D.

**Papel de Las Instrucciones y la Regulacion Verbal en la Facilitacion y/o Transformacion de Diferentes Relaciones Derivadas**

Chair and Discussant: Mapy Chavez Cueto (Alcanzando)

**Transformacion Derivada de Funciones en el Marco de Coordinacion y Oposicion de Acuerdo Con Equivalencia** Dyanne Ruíz Casteñeda (Universidad de Almeria), BELÉN RODRÍGUEZ FERRARI and Mapy Chavez Cueto (Alcanzando), and Inmaculada Gómez Becerra (Universidad de Almeria)

**Procedimientos de Facilitacion de Equivalencia-Equivalencia en Niños y Habilidades Prerrequisitas** Rosa García Barranco Brranco (University of Almeria), PATRICIA MARTINELLI VARGAS and Mapy Chavez Cueto (Alcanzando), and Inmaculada Gómez Becerra (Universidad de Almeria)

**La Regulacion Verbal y Su Implicacion en la Infancia** Dyanne Ruíz Casteñeda (Universidad de Almeria), GRACIELA CACERES AGURTO and Mapy Chavez Cueto (Alcanzando), and Inmaculada Gómez Becerra and Rosa García Barranco (Universidad de Almeria)

**# 38 Paper Session**

---

6:30 pm–6:50 pm

Salon Mérida (Fiesta Americana)

EAB

***Mexican Journal of Behavior Analysis***

Chair: Alicia Roca (Universidad Nacional Autónoma de México)

***Mexican Journal of Behavior Analysis*** (Experimental Analysis) ALICIA ROCA (Universidad Nacional Autónoma de México)

**# 40 Poster Session**

---

7:00 pm–9:00 pm

Gran Salon Yucatan (Fiesta Americana)

EAB

**2. On the Role of Sorting** (VRB; Experimental Analysis) AINA NORBOM and Erik Arntzen (Oslo and Akershus University College) and Lanny Fields (Queens College, City University of New York)



- 3. Everything You Know About the Experimental Analysis of Behavior Is Wrong (Theory)** RICHARD W. MALOTT (Western Michigan University)
- 4. Effects of Changes in the Quantity of Modalities on the Acquisition and Transfer of Conditional Discrimination** (Experimental Analysis) LUIS ALBERTO QUIROGA BAQUERO, Carlos Wilcen Villamil Barriga, and Carlos Javier Flores Aguirre (Universidad de Guadalajara) and Paola Andrea Arrubla (Fundacion Universitaria Konrad Lorenz)
- 5. Operant Contingencies for Collaboration Between Chimps** (Experimental Analysis) PER HOLTH (Oslo and Akershus University College)
- 6. Assessing Mindfulness Processes in Emotional Regulation: A Translational Study** (VRB; Experimental Analysis) YORS A. GARCIA, Liliana Cristiano, and Sergio Ribero (Fundacion Universitaria Konrad Lorenz)
- 7. The Effects of (Un)predicable and (Un)controllable Stimuli Upon New Learning** (Experimental Analysis) JOSELE ABREU-RODRIGUES and Lorena Kássia de Lima (Universidade de Brasília)
- 8. Response Acquisition With Delayed Conditioned Reinforcement** (TPC; Experimental Analysis) MARCO PULIDO (Universidad Intercontinental) and Rodrigo Sosa (Universidad de Guadalajara)
- 9. Response Variability During Continuous Reinforcement, Intermittent Reinforcement, and Extinction: A Reappraisal of Antonitis** (Experimental Analysis) NADIA SANTILLÁN and Rogelio Escobar (Universidad Nacional Autónoma de México)
- 10. Transformation of Emotional Functions Across Comparative Relational Networks: A Functional Account of Transitive Inference** (VRB; Experimental Analysis) MICAH AMD and Dermot Barnes-Holmes (National University of Ireland, Maynooth)
- 11. Renewal of Acquired and Then Extinguished Avoidance Behavior in Rats: Two Single-Subject Experiments** (CBM; Experimental Analysis) SADAHIKO NAKAJIMA and Hiroya Nakagawa (Kwansei Gakuin University)
- 12. Analysis of Experimental and Extra-Experimental Variables in Stimulus Class Formation** (VRB; Experimental Analysis) ALVARO TORRES CHAVEZ and Angel Tovar y Romo (Universidad Nacional Autónoma de México)
- 13. Number of Skills Assessment in Autistic Students** (AUT; Experimental Analysis) CAMILA STRAFORIN OLIVEIRA (Universidade Paulista) and João Carmo dos Santos (Universidade Federal de São Carlos)
- 14. Experimental Model for the Study of Substitutive Interactions in the Alcohol Use Disorder: A Methodological Proposal** (Experimental Analysis) GISELL ANAID REAL, Maria de los Angeles Vacio, and Martha Leticia Salazar (Universidad Autónoma de Aguascalientes)

- 15. Effects of Two Procedures of Contingency Suspension Between Aggregate Product and Cultural Event in a Laboratory Microculture** (TPC; Experimental Analysis)  
NATALIA SANTOS MARQUES and Marcelo Frota Benvenuti (Universidade de São Paulo)
- 16. The Response Allocation of Day Care Children as a Function of Social Reinforcer Ratios** (AUT; Applied Behavior Analysis) PIER-OLIVIER CARON, Jacques Forget, and Mélima Rivard (Université du Québec à Montréal)
- 17. Experimental Evidence of the Sequential Choice Model in Humans** (Experimental Analysis) ÓSCAR GARCÍA-LEAL and Enzo Leandro Rodríguez Macías (Universidad de Guadalajara)
- 18. Novelty Seeking and Risk Sensitivity** (Experimental Analysis) ÓSCAR GARCÍA-LEAL and Héctor Octavio Camarena (Universidad de Guadalajara)
- 19. Sensory Preconditioning in a Feature-Positive Discrimination** (Experimental Analysis) GABRIEL VELÁZQUEZ GONZÁLEZ and Maricela Flores (Universidad de Guadalajara) and Carlos Flores Aguirre (Centro de Estudios e Investigacion en Comportamien)
- 20. Design of an Experimental Task to Assess Control Resource Style** (CSE; Applied Behavior Analysis) ANA DEL R. CERVANTES- HERRERA and Francisco J. Pedroza-Cabrera (Universidad Autónoma de Aguascalientes)
- 21. Varied Training in a Competence and its Transference to a Different Level of Functional Aptitude** (Experimental Analysis) MAURICIO ROMO and Maria Elena Rodríguez Pérez (Universidad de Guadalajara)
- 22. Sensitivity to Delay of Reinforcement in an Animal Model of ADHD** (Experimental Analysis) MARICRUZ VARGAS, Gaytan Mariana, and Vladimir Orduna (Universidad Nacional Autónoma de México)
- 23. Sensitivity to Magnitude of Reinforcement in an Animal Model of ADHD** (Experimental Analysis) GAYTAN MARIANA, Maricruz Vargas, and Vladimir Orduna (Universidad Nacional Autónoma de México)
- 24. Role of Naming in Equivalence Class Formation** (VRB; Experimental Analysis) HANNE AUGLAND, Camilla Harangen, and Erik Arntzen (Oslo and Akershus University College)
- 25. Expanding Classes in Equivalence Class Formation** (VRB; Experimental Analysis) CAMILLA HARANGEN, Hanne Augland, and Erik Arntzen (Oslo and Akershus University College)
- 26. Intertrial Intervals and Contextual Conditioning in an ABA Renewal Procedure** (CBM; Experimental Analysis) RODRIGO CARRANZA JASSO, Javier Nieto Gutierrez, and Livia Sánchez Carasco (Universidad Nacional Autónoma de México)
- 28. Acquisition of Taste Aversion Learning Is Context-Dependent?** (AAB; Experimental Analysis) Livia Sánchez Carasco, BRENDA ESPINOSA-ESTEBAN, and Alma Pérez-Lopez (Universidad Nacional Autónoma de México)

- 29. How Low Acquisition Reinforcement Rates Affect ABA Instrumental Renewal?** (Experimental Analysis) YULTZIN GAONA ADAME, Alejandra Valadez Vergara, Eduardo Parra García, and Livia Sánchez Carasco (Universidad Nacional Autónoma de México)
- 30. Individual Consistencies in Behavior in an Ambiguous Situation: An Experimental Proposal** (Experimental Analysis) ELIA NATALIA FUENTES GONZÁLEZ, Carlos Torres, and Nora Rangel (Universidad de Guadalajara)
- 31. Compound Stimulus Effects on Temporal Control Acquisition** (Experimental Analysis) MARINA MENEZ DIAZ, Sarahi Gallardo, Florente López (Universidad Nacional Autónoma de México)
- 32. Relating to Values: Transformation of Values Functions to Arbitrary Stimuli** (Experimental Analysis) STEPHANIE CALDAS, Gina Quebedeaux, Emmie Hebert, and Shelley Greene (University of Louisiana at Lafayette); Michael Bordieri (University of Mississippi); and Emily Kennison Sandoz (University of Louisiana at Lafayette)
- 33. Reinforcement of a Competitive Response During Extinction Does Not Affect Instrumental Renewal** (Experimental Analysis) EDUARDO PARRA GARCÍA, Alejandra Valadez Vergara, Yultzin Gaona Adame, and Livia Sánchez Carasco (Universidad Nacional Autónoma de México)
- 34. Renewal of Lever Pressing Depends on Acquisition Rate of Response** (AAB; Experimental Analysis) ALEJANDRA VALADEZ VERGARA, Yultzin Gaona Adame, Eduardo Parra García, and Livia Sánchez Carasco (Universidad Nacional Autónoma de México)
- 35. The Acquisition of Temporal Control: The Role of Prior Reinforcement Contingencies** (Experimental Analysis) SARAHI GALLARDO, Florente López, Marina Menez Diaz (Universidad Nacional Autónoma de México)
- 36. Establishment and Emergence of Equivalence Relations Between Auditory Stimuli (Musical Sounds) and Arbitrary Visual Stimuli** (Experimental Analysis) LUIS CARLOS FONSECA LEON (Center for Behavior Studies and Research, Universidad de Guadalajara)
- 37. ABA, ABC, and AAB Renewal in Humans** (PRA; Experimental Analysis) DIEGO MARTIN SANCHEZ, Jovany Salazar Ramirez, Ximena Salinas Hernández, and Livia Sánchez Carasco (Universidad Nacional Autónoma de México)
- 38. Effects of Acute Caffeine Dosage on Fixed-Ratio Rate of Responding on Goldfish** (BPH; Experimental Analysis) ANITA LI, Joshua K. Pritchard, and Ryan Lee O'Donnell (Florida Institute of Technology)
- 39. The Gold Fish See: An Examination Into Primary Reinforcers for *Carassius auratus*** (Experimental Analysis) NICOLE HIGGINS, Whitney Bowman, Brendan J. Boehr, and Joshua K. Pritchard (Florida Institute of Technology)

- 40. Effects of Varying the Spatial Position of the Signaling and Water on the Differential Adjustment** (Experimental Analysis) FELIPE PATRÓN (Universidad de Guadalajara)
- 41. Behavioural Critical Flicker Fusion Frequency in Zebrafish** (Danio rerio) (Experimental Analysis) KAZUCHIKA MANABE (Nihon University), Robert Dooling (University of Maryland), and Shinichi Takaku (Nihon University)
- 42. The Differential Outcomes Effect in Humans Using a Many-to-One Matching-to-Sample Task and Sensory Outcomes** (AAB; Experimental Analysis) Carlos Flores and REBECA MATEOS MORFÍN (Universidad de Guadalajara)
- 43. Differences in Delay Discounting and Probability Discounting Rates With Two Types of Rewards in Drug Users** (CBM; Experimental Analysis) DIANA MEJÍA CRUZ, Javier Nieto Gutierrez, Silvia Morales, and Raul Avila (Universidad Nacional Autónoma de México)
- 44. Identification of Intraindividual Consistencies in a Persistence of Achievement Contingency** (Experimental Analysis) ANGELICA NUÑO FRAGOSO, Maria Elena Rodríguez Pérez, and Nora Rangel (Universidad de Guadalajara)
- 45. Differential Outcomes in a Feature Ambiguous Discrimination Task** (Experimental Analysis) MARICELA FLORES, Gabriel Velazquez, and Carlos Flores (Universidad de Guadalajara)
- 46. Effects of Exposing Students to Technical Terminology and Ordinary Language to Explain Psychological Phenomena** (VRB; Experimental Analysis) MARÍA ANTONIA PADILLA VARGAS and Alejandra Isabel Rodríguez Núñez (Universidad de Guadalajara)
- 47. Effects of Task Segmentation on Procrastination** (Experimental Analysis) GERARDO TORRES, María Antonia Padilla Vargas, and Cristiano Dos Santos (Universidad de Guadalajara)
- 48. Evidence Against Anticipatory Hunger** (Experimental Analysis) VARSOVIA HERNANDEZ ESLAVA and Carlos A. Bruner (Universidad Nacional Autónoma de México)
- 49. Behavior Under Nonverbal Transitive-Inference Procedures: Transitivity Without Awareness, Value Transfer, or Stimulus Control?** (Experimental Analysis) ANN GALIZIO and Adam H. Doughty (College of Charleston), Dean C. Williams and Kathryn Saunders (University of Kansas), and Alyssa L. Kresselman (College of Charleston)
- 50. Trace Conditioning in a Neural-Network Model** (Theory) EMETH DELGADO PÉREZ and José Enrique Burgos Triano (Universidad de Guadalajara)
- 51. Context Specificity of Trace Conditioning in a Neural-Network Model** (Theory) EMETH DELGADO PÉREZ and José Enrique Burgos Triano (Universidad de Guadalajara)

- 52. Training in Language Reactive Modes and Its Effect on the Active Write Mode** (VRB; Experimental Analysis) ENRIQUE ZEPETA GARCIA, Agustin Daniel Gómez Fuentes, Josue Antonio Camacho Candia, Sarai Arias Pérez, and Minerva Pérez Juárez (Universidad Veracruzana)
- 53. Strategic Concerns in Social Traps: An Experimental Analysis** (CSE; Experimental Analysis) LUIS FERNANDO GONZÁLEZ-BELTRÁN and Carlos Santoyo Velasco (Universidad Nacional Autónoma de México)
- 54. A Happy Superiority in IRAP Tasks** (VRB; Experimental Analysis) RENATO BORTOLOTTI and Julio C. De Rose (Universidade Federal de São Carlos)
- 55. Effect of Definitional and Constative Texts on Reading Comprehension** (VRB; Applied Behavior Analysis) CECILIA MAGDALENA MOLINA LPEZ, María Enriqueta Sánchez Hernández, Agustin Daniel Gómez Fuentes, and Enrique Zepeta Garcia (Universidad Veracruzana)
- 56. Effect of Three Learning Strategies on Different Aptitude Levels** (VRB; Applied Behavior Analysis) CECILIA MAGDALENA MOLINA LPEZ, José Antonio Cruz Gómez, Carlos Ibáñez-Bernal, and Enrique Zepeta Garcia (Universidad Veracruzana)
- 57. Overweight and Obesity in Children: Application of the Matching Law** (CBM; Applied Behavior Analysis) ALEJANDRA CAVITA, Anayeli Hernández, and Ariel Vite Sierra (Universidad Nacional Autónoma de México)
- 58. Motivational and Instructional Variables on Verbal and Nonverbal Behavior in a Time-Based Task** (TPC; Experimental Analysis) THAIS FERRO NOGARA (Universidade Federal de Mato Grosso) and Marcelo Frota Benvenuti (Universidade de São Paulo)
- 59. Learned Helplessness Does Not Depend on the Estrous Cycle in Female Rats** (Experimental Analysis) TATIANY PORTO and Maria Helena Hunziker (Universidade de São Paulo)
- 60. Response Acquisition With Conditioned Reinforcement: Effects of Stimulus-Food Frequency Pairings** (Experimental Analysis) KARINA BERMUDEZ and Carlos A. Bruner (Universidad Nacional Autónoma de México)
- 61. Extension of Conditional Control in Preschoolers** (EDC; Experimental Analysis) MARIANA MICCIONE and Grauben Assis (Federal University of Pará) and João Carmo dos Santos (Universidade Federal de São Carlos)
- 62. Effect of Novelty in a Contingential Arrangement of Curiosity** (DEV; Experimental Analysis) MARÍA ESTHER VALLE MORFÍN and María Elena Rodríguez Pérez (Universidad de Guadalajara)
- 63. Reinforcer Availability and Eating Behavior in Rats** (Experimental Analysis) IRERI BRAVO MENDEZ, Emmanuel Flores Michel, and Felipe Diaz (Universidad de Guadalajara)

**64. Effects of a Interpersed Training Procedure for the Establishment of the Contextual Control Over Recombined Conditional Relations** (TPC; Experimental Analysis) TATIANE CARVALHO CASTRO, Mateus G. N. dos Santos Gonçalves Nogueira, Kaíque Porto, and A. Celso Goyos (Universidade Federal de São Carlos)

**65. Parametric Food Deprivation in Rats** (Experimental Analysis) FELIPE DIAZ (Universidad de Guadalajara)

---

**# 41 Poster Session**

7:00 pm–9:00 pm

Gran Salon Yucatan (Fiesta Americana)

TPC

**66. An Attempt to Unify Self-Control Paradigms via a Pavlovian/Operant Approach** (EAB; Theory) RODRIGO SOSA and Cristiano Dos Santos (Universidad de Guadalajara)

**67. Philosophical Underpinnings of Scholarly Works in Behavioral Journals: American and International Trends** (Theory) GENEVIEVE M. DEBERNARDIS, Linda J. Parrott Hayes, and Maria Isabel Munoz Blanco (University of Nevada, Reno)

**68. Illustration of Recommendations From Two Empirical Studies on Verbal Behavior by Presenting a Case of Low-Intensity Intervention for a Child With ASD** (Theory) GISELA REGLI (Quebec ABA) and Melina Rivard (Université du Québec à Montréal)

**69. A Rose by Any Name: The Varied Nomenclature of Behaviorism** (Theory) BRENDAN J. BOEHR and Joshua K. Pritchard (Florida Institute of Technology)

**70. Predictors for the Provision of Publicly Funded Service for Children With Autistic Disorder** (AUT; Service Delivery) DANETTE MONTIEL (Institute for Applied Behavior Analysis)

---

**# 42 Poster Session**

7:00 pm–9:00 pm

Gran Salon Yucatan (Fiesta Americana)

EDC

**71. The Effect of a Momentum Enhancement on the Performance of Students With Behavior Disorders** (Applied Behavior Analysis) MICHAL HIRSCHMANN (Kibbutzim College), Orit Hetzroni (Haifa University), and Eitan Eldar (Kibbutzim College)

**72. Stress and Undergraduates' Social Skills** (PRA; Applied Behavior Analysis) JUNNIA MARIA MOREIRA, Lena Vitória de Oliveira, Isis Valença, and Keyciane Figueredo Mercedes de Oliveira (Universidade Federal do Recôncavo da Bahia)

**73. Raising the Confidence Coefficient: Derived Relational Responding, Statistics Anxiety, and Core Statistics Skills** (Experimental Analysis) ASHLYNE MULLEN and Emmie Hebert (University of Louisiana at Lafayette), Michael Bordieri (University of Mississippi), and Emily Kennison Sandoz (University of Louisiana at Lafayette)

- 74. Teaching Addition and Subtraction Skills to Elementary School Children** (EAB; Experimental Analysis) Priscila Gualberto and JOÃO CARMO DOS SANTOS (Universidade Federal de São Carlos)
- 75. Some Effects of Equivalence Class Formation Over the Solution of Addition and Subtraction Problems** (PRA; Applied Behavior Analysis) MARCELO HENRIQUE OLIVEIRA HENKLAIN and João S. Carmo (Universidade Federal de São Carlos)
- 76. Desarrolla de Habilidades Científicas en Estudiantes Universitarios: Un Analisis Experiemental de la Secuencia de Tareas** (Experimental Analysis) WINTER EDGAR REYNA CRUZ, Alejandro Cerón Martiñez, Veronica Luna Hernández, Leslie Valeria Briseño Zamora, and Christian Cruz (Universidad Nacional Autónoma de México)
- 77. Structured but Adaptable Methods for Documenting and Improving Interventionists' Implementation Integrity** (PRA; Service Delivery) JOHN C. BEGENY, Jessica Loehman, Rebecca Levy, Kristina Rodríguez, Ashley Collins, and Katelyn Bigelow (North Carolina State University) and Ho Yan Tsuen (Guilford County School District)
- 78. Digital Skills Program for Increasing Teachers Academic Skills** (TBA; Applied Behavior Analysis) MARCO WILFREDO SALAS-MARTINEZ, Omar Torres Fernández, Esperanza Ferrant-Jimenez, Andree Fleming-Holland, and Martín Luís Ortíz Bueno (Universidad Veracruzana)
- 80. The Effect of Temporal Distribution of Practice Opportunities on the Efficient Acquisition of Novel Terms** (TBA; Applied Behavior Analysis) MARGARET DANNEVIK (Here We Go! Lasting Behavior Change, LLC)
- 81. Teaching Basic Skills of Statistics in High School Students** (TBA; Applied Behavior Analysis) ESPERANZA FERRANT-JIMENEZ, Diana Elizabeth Pedraza Valderrábano, Marco Wilfredo Salas-Martínez, and Martín Luís Ortíz Bueno (Universidad Veracruzana)
- 82. Development of Academic and Linguistic Skills for Reading and Writing** (VRB; Applied Behavior Analysis) ELVIA PERALTA GUERRA, Ariadna Andrade Aguilar, and Geronimo Reyes Hernández (Universidad Veracruzana)
- 83. Effects of a Program of Health Promotion in Preschool Competencies** (Applied Behavior Analysis) MARÍA MARCELA CASTAÑEDA MOTA and Dora Granados Ramos (Universidad Veracruzana)
- 83a. Home Schooling Approach to a Child With Atypical Development: Effects of Reading and Numeracy Programs Through Quivalence Relations** (Applied Behavior Analysis) LUIZA HÜBNER OLIVEIRA (private practice) and Daniela Landim and Martha Hübner (Universidade de São Paulo)

### # 43 Poster Session

---

7:00 pm–9:00 pm

Gran Salon Yucatan (Fiesta Americana)

TBA

**84. The Effects of Parent Training on Problem Behaviors** (PRA; Applied Behavior Analysis) MARISSA JEAN TYBOR (The Chicago School of Professional Psychology)

### # 44 Poster Session

---

7:00 pm–9:00 pm

Gran Salon Yucatan (Fiesta Americana)

CSE

**85. Using a Health Action Process Approach to Facilitate Health Behaviors for Rheumatoid Arthritis Patients** (DEV; Applied Behavior Analysis) SUSAN BAXTER, Gareth Treharne, Cath Smith, Simon Stebbings, and Leigh Hale (University of Otago)

**86. Analisis Experimento de la Conducta de Temor Desde una Aproximacion Interconductual** (Experimental Analysis) LESLIE VALERIA BRISEÑO ZAMORA, Veronica Luna Hernández, Christian Cruz, Alejandro Cerón Martínez, and Winter Edgar Reyna Cruz (Universidad Nacional Autónoma de México)

**87. Gaining Consumer Buy-In: Parent Evaluations of the Social Validity of Social Skill Interventions** (Service Delivery) TANYA RUTHERFORD, James Vogel, and Debra Berry Malmberg (California State University, Northridge)

**88. Una Propuesta Para el Analisis Experimental de Mentir Desde el Interconductismo** (Experimental Analysis) VERONICA LUNA HERNANDEZ, Christian Cruz, Alejandro Cerón Martínez, Leslie Valeria Briseño Zamora, and Winter Edgar Reyna Cruz (Universidad Nacional Autónoma de México)

**89. Effectively Translating Indirect Assessments With an Eye Toward Reliability and Validity** (Applied Behavior Analysis) CRISTINA VEGA (SEEK Education, Inc.), Michele D. Wallace (California State University, Los Angeles), Marisela Alvarado (Foothill Child Development Services Inc.), and Adriana Gracias (A.B.E.D.I., Inc.)

### # 45 Poster Session

---

7:00 pm–9:00 pm

Gran Salon Yucatan (Fiesta Americana)

OBM

**90. Reducing Nonfatal Occupational Injuries Among Hispanic Workers With the Implementation of Behavior-Based Safety Training in Spanish** (Applied Behavior Analysis) SIN CHIEN LEE and Douglas A. Johnson (Western Michigan University) and Angela R. Lebbon (Lehman College, City University of New York)

**91. Understanding the Impacts of Advertisements in Social Networking Sites** (Applied Behavior Analysis) ASLE FAGERSTRØM (The Norwegian School of Information Technology) and Maria Lillemoen (Oslo and Akershus University College)



**92. Coping With Stress After a Downsizing in a Mexican Retail Company** (DEV; Applied Behavior Analysis) REBECA GONZALEZ (Monterrey Technological Institute)

**93. The Monetary Effect of Performance Management Compared to Traditional Management Using Historical Data** (TPC; Applied Behavior Analysis) MARI D. SOLHEIM and Ingunn Sandaker (Oslo and Akershus University College) and Tom Endresplass (Quality Manager, Maze Feedback AS)

**94. An Experimental Study of Escalation in Information Technology Projects** (Applied Behavior Analysis) HILDE MOBEKK (Oslo and Akershus University College), Asle Fagerstrøm (The Norwegian School of Information Technology), and Donald A. Hantula (Temple University)

---

#### **# 46 Poster Session**

7:00 pm–9:00 pm

Gran Salon Yucatan (Fiesta Americana)

AAB

**95. Development of Chicks' Choice Responses Reinforced by Either an Imprinted Stimulus or Food Under Concurrent Schedules of Reinforcement** (Applied Behavior Analysis) FUKUKO HASEGAWA and Tetsumi Moriyama (Tokai University)

**96. In Search for Establishing Conditional Discriminations in Dogs** (EAB; Experimental Analysis) EDSON HUZIWARA, Deisy das Graças de Souza, and Tathianna Montagnoli (Universidade Federal de São Carlos)

---

#### **# 47 Poster Session**

7:00 pm–9:00 pm

Gran Salon Yucatan (Fiesta Americana)

CBM

**97. Binge Eating Behavior and Quality of Life in Obese Adults** (Service Delivery) KARINA FRANCO and Iván Alejandro Muñoz González (Centro Universitario del Sur) and Felipe Diaz (Universidad de Guadalajara)

**98. The Role of Clinical Behavior Analysis in a Multidisciplinary Outpatient Pediatric Pain Management Program** (Service Delivery) SARAH N. VERLEE, Timothy P. Smith, Todd Degenhart, Steve Drugan, and Kathleen Lemanek (Nationwide Children's Hospital)

**99. Does Feedback of Energy Exertion Affect Post-concussion Symptoms?** (CSE; Applied Behavior Analysis) WILLIAM J. WARZAK and Silvina Salvi (University of Nebraska Medical Center), Sela Ann Sanberg (University of Nebraska Medical Center, California), Louis Morales Knight (Boys Town), and Brigid Vilardo (University of Nebraska Medical Center)

**100. Depression and Suicidal Ideation in College Students of Different Careers in Mexico** (EDC; Applied Behavior Analysis) NORMA COFFIN, Constanza Miralrio Medina, Monica Alvarez Zuñiga, Lourdes Jimenez Renteria, Clara Bejar Nava, and Francisca Bejar Nava (Universidad Nacional Autónoma de México)

**101. The Microcontingential Analysis as Analytical System of the Healthy Behavior** (PRA; Applied Behavior Analysis) DIANA MORENO RODRÍGUEZ, Susana Robles Montijo, Erika Cadena Ortíz, Betariz Frías Arroyo, Martha Rodríguez Cervantes, and Rodolfo Barroso Villegas (Universidad Nacional Autónoma de México)

**102. Intervention to Increase Verbal Operants and Decrease Problem Behavior in a Person Diagnosed With Aphasia** (VRB; Applied Behavior Analysis) ALICIA ROCA (Universidad Nacional Autónoma de México)

**103. The Behavior of Therapist and User and Their Connection With the Drug Abuse Recovery** (BPH; Applied Behavior Analysis) JUDITH ELISA FERRER ALARCÓN and Silvia Morales Chainé (Universidad Nacional Autónoma de México)

**104. Risk Factors Associated to Gambling Behavior** (CSE; Applied Behavior Analysis) ALEJANDRA LOPEZ MONTOYA and Silvia Morales Chainé (Universidad Nacional Autónoma de México)

**105. Child Behavior Problems Like Alcohol Predecessors in Adolescents** (Applied Behavior Analysis) ALEJANDRA MONSERRAT RIVERA BARRIENTOS and Silvia Morales Chainé (Universidad Nacional Autónoma de México)

#### **# 48 Poster Session**

---

7:00 pm–9:00 pm

Gran Salon Yucatan (Fiesta Americana)

DEV

**106. The Use of Stimulus Equivalence to Teach a Second Language to a Child With Autism** (Applied Behavior Analysis) MARISELA ALVARADO, Cristina Vega, Katrina Babalian, Adriana Gracias, and Nicolette Montanez (Foothill Child Development Services, Inc.)

#### **# 49 Poster Session**

---

7:00 pm–9:00 pm

Gran Salon Yucatan (Fiesta Americana)

PRA

**107. Teaching Numeracy Skills in Early Childhood Classrooms: Embedding Learning Opportunities and Using a Most-to-Least Prompting Strategy** (DDA; Service Delivery) SUSAN JOHNSTON and Lisa Davenport (University of Utah)

**108. Positive Behavioral Supports in Inclusive Middle School Classes** (EDC; Applied Behavior Analysis) VALERIE DYAL (Weilenmann School of Discovery) and Susan Johnston (University of Utah)

## # 50 Poster Session

---

7:00 pm–9:00 pm

Gran Salon Yucatan (Fiesta Americana)

VRB

**109. The Effects of Contextualized and Decontextualized Stories With Autoclitics Upon Nonverbal Behavior** (EAB; Experimental Analysis) FELIPE GOMES, Luis Antonio Lovo Martins, Sidinei Rolim, Marcos Garcia, Martha Hübner, and Paulo Abreu (Universidade de São Paulo)

**110. The Ether of Skinner's Analysis of Verbal Behavior. The Autoclitic** (TPC; Theory) KENNETH W. JACOBS and Linda J. Parrott Hayes (University of Nevada, Reno)

**111. An Analysis of Self-Editing as a Function of the Controlling Environment** (TPC; Theory) DOMINIQUE STEDHAM and Linda J. Parrott Hayes (University of Nevada, Reno)

**112. An Examination of an Automated Computer Program for Teaching Deictic Relational Responding to Children** (DEV; Applied Behavior Analysis) RYAN LEE O'DONNELL, Joshua K. Pritchard, and Anita Li (Florida Institute of Technology)

**113. Retrospective Protocols and Tower of London: A Comparison of Children and Adults** (EAB; Experimental Analysis) Hortensia Hickman, Maria Luisa Cepeda Islas, Diana Moreno Rodríguez, Patricia Plancarte, NOE GRACIDA, Viridiana Ruíz, and Rosalinda Arroyo (Universidad Nacional Autónoma de México)

## # 51 Poster Session

---

7:00 pm–9:00 pm

Gran Salon Yucatan (Fiesta Americana)

DDA

**114. The Effect of Community-Based Job Training on the Acquisition of Apartment Management Skills of a High School Student With Intellectual Disabilities** (CSE; Experimental Analysis) KYUNGSOOK KANG (Wonkwang University)

**115. The Effects of the Picture Exchange Communication System on the Acquisition and Generalization of Mands for Adults With Developmental Disabilities and Severe Communication Deficits** (PRA; Applied Behavior Analysis) MARY VON WITZLEBEN (ZDP Associates)

## # 52 Poster Session

---

7:00 pm–9:00 pm

Gran Salon Yucatan (Fiesta Americana)

AUT

**116. Behavior Analysis Training System** (Applied Behavior Analysis) RICHARD W. MALOTT and Ali Markowitz (Western Michigan University)

- 117. The Effects of Functional Assessment-Based Intervention on Problem Behaviors of a Student With Autism and Visual Impairments** (CBM; Applied Behavior Analysis) JUNG YEON CHO (Daegu Cyber University)
- 118. A Replication of Wilson's Generic Habit-Training Program to Toilet Train Students With Autism in School and Home Settings** (DDA; Applied Behavior Analysis) KATHLEEN MCCABE-ODRI, Jennifer Cornely, Lauren DeGrazia, Nicole M. Rzemlyk, and Nicole Pease (Partners in Learning, Inc.)
- 119. UNT Behavior Analysis Online** (DDA; Applied Behavior Analysis) SUSAN R. MILLER and Sigrid S. Glenn (University of North Texas)
- 120. Acquisition and Generalization of Mands Learned via Picture Exchange Communication System for Autistic Children** (VRB; Experimental Analysis) THAIS PORLAN DE OLIVEIRA, Juliana Campos de Jesus, Junio Vieira de Rezende, Xilander Rocha Resende, and Rafael da Costa Silva (Universidade Federal de Minas Gerais)
- 121. Effective Applications of ABA With a Nonverbal Child With Autism** (EDC; Applied Behavior Analysis) DONNA KEARNS (University of Central Oklahoma)
- 122. Empowering Parents as Instructors: Using Video Modeling to Teach Parents to Use Visual Supports With Their Children With Autism** (Applied Behavior Analysis) DAISY WANG (University of British Columbia), Dianna Hiu Yan Yip and Noreen Dunn Chiu (none), Katrina Isabella McGee (Beanstalk Behaviour Consulting), and Parbinder Bains (University of British Columbia)
- 123. Influence of Cultural Background From Families With Children Having ASD in Trajectory Services and in Effective Application of EIBI** (CSE; Service Delivery) MELINA RIVARD and Marie Millau (Université du Québec à Montréal)
- 124. A Collaborative Parent Education Program Teaching Parents to Use Naturalistic Teaching Strategies** (Applied Behavior Analysis) TANYA RUTHERFORD, Amanda Finch, and Debra Berry Malmberg (California State University, Northridge)
- 126. Optimizing the Learning Environment in Natural Settings by Manipulating Pre-sessions Motivating Operations** (EAB; Applied Behavior Analysis) CHATURI EDRISINHA and Ofelia Tipu (St. Cloud State University), Mark O'Reilly (University of Texas at Austin), Russell Lang (Texas State University, San Marcos), and Mary B Noll (St. Cloud State University)
- 127. A Meta-analysis of Activity Schedules for Children and Adolescents With Autism Spectrum Disorders** (DDA; Applied Behavior Analysis) DERYA GENÇ and Serife Yucesoy Ozkan (Anadolu University)
- 128. A Comparison of Simultaneous Prompting Procedure With High and Low Treatment Integrity** (DDA; Applied Behavior Analysis) ONUR KURT, Derya Genç, and Elif Tekin-Iftar (Anadolu University)

**129. Helping a Child With Autism to Interact With Peers at School: Effects of Setting Joint Playtime and Social Skills Training** (Applied Behavior Analysis)  
KAZUKI NIWAYAMA and Junko Tanaka-Matsumi (Kwansei Gakuin University)

**132. Using Sensorimotor Play as a Setting Event for the Rapid Acquisition of Core Sociocommunicative Behaviors in a Child With Autism** (PRA; Applied Behavior Analysis)  
Mallory Smith and GIA VAZQUEZ ORTEGA (Blossom Center for Children)



  
Association for Behavior Analysis International  
[www.abainternational.org](http://www.abainternational.org)

abai  
**CHICAGO**  
40TH ANNUAL CONVENTION

May 23–27  
2014  
McCormick Place  
2301 S. Lakeshore Drive  
Chicago, IL 60616

Learn more at  
<http://www.abainternational.org/events/annual-2014.aspx>





**SEVENTH  
INTERNATIONAL  
CONFERENCE:** **MÉRIDA** MEXICO

**TUESDAY, OCTOBER 8**

**Schedule Overview  
Invited and Breakout Sessions  
Closing Ceremony**

Seventh International Conference; Tuesday, October 8



	Room	8 am		9 am		10 am		11 am		12 pm		1 pm		2 pm	
		:00	:30	:00	:30	:00	:30	:00	:30	:00	:30	:00	:30	:00	:30
Fiesta Americana Floor 2	Gran Salon Yucatan														
	Yucatan I														
	Yucatan II		#54 TPC Reese *†		#59 EAB Pellón *†				#61 OBM Malott *†		#68 TPC Marr *†		#75 TBA Pear *†		#81 TPC Ch. Hübner *†
	Yucatan III		#56 CSE Ch. Murphy			#60 CBM Ch. Fleming-Holland	Coffee Break	#66 EAB Ch. Serrano esp.			#72 EAB Ch. Ibáñez-Bernal esp.			#79 EAB Ch. Pitts	
	Yucatan IV		#55 AUT Ch. Beirne					#64 EAB Ch. Gomez Fuentes esp. *			#69 DEV Ch. Pelaez			#78 EAB Ch. Padilla Vargas	
	Salon Mérida		#57 TBA Ch. Thompson					#67 EDC Ch. Twyman			#71 EAB Ch. Flores Aguirre esp.			#76 EAB Ch. Nieto Gutierrez esp.	
	Salon Celestun							#63 EDC Ch. Long *			#73 OBM Ch. Robertson			#80 PRA Ch. Hughes esp.	
	Santa Lucia		Staff Office												
	Valladolid		Speaker Ready Room												
Fiesta Americana Floor 1	Izamal		#58 TPC Ch. Benvenuti			Coffee Break	#65 TPC Ch. Pedroza-Cabrera esp.			#74 TPC Ch. Ángel González esp.			#82 VRB Ch. Fryling		
Presidente Hotel	Gran Salon I														
	Gran Salon II		#53 AUT Ch. Mounger				Coffee Break	#62 CSE Ch. Rivard			#70 EAB Ch. Abreu-Rodrigues			#77 EAB Ch. Abreu-Rodrigues	



Seventh International Conference; Tuesday, October 8

3 pm		4 pm		5 pm		6 pm		7 pm		8 pm		9 pm		Room	Fiesta Americana Floor 2
:00	:30	:00	:30	:00	:30	:00	:30	:00	:30	:00	:30	:00	:30		
														Gran Salon Yucatan	
	Closing Event													Yucatan I	
#81 cont.														Yucatan II	
#79 cont.														Yucatan III	
#78 cont.														Yucatan IV	
#76 cont.														Salon Mérida	
#80 cont.														Salon Celestun	
Staff Office														Santa Lucia	
Mtg Space														Valladolid	
														Izamal	Fiesta Americana Floor 1
														Gran Salon I	Presidente Hotel
#77 cont.														Gran Salon II	

**LEGEND**

-  = Special and Invited Events
-  = ABAI Services and staff rooms
-  = Food and Beverage
- esp.** = *Presentation in Spanish*
- \*** = CE for Behavior Analysts
- †** = CE for Psychologists
- Ch.** = Chairperson

## # 53 Paper Session

---

8:30 am–9:20 am

Gran Salon II (Presidente Intercontinental)

AUT

### Positive Practices and Teaching Strategies

Chair: Stephanie Mounger (none)

**The Use of Visual Barrier Blinders to Reduce Off-Task Behavior Maintained by Sensory Reinforcement** (Applied Behavior Analysis) STEPHANIE MOUNGER (none)

**Teaching Intraverbal Behavior to Children With Autism: A Comparison of Echoic and Textual Transfer of Stimulus Control Procedures** (Applied Behavior Analysis) JENNY LEANN PAGAN (Quest Kids) and Ada C. Harvey and Elbert Q. Blakely (Florida Institute of Technology)

## # 54 Invited Presenter

---

8:30 am–9:20 am

Yucatan II (Fiesta Americana)

TPC; Theory

PSY/BACB CE Offered. CE Instructor: Hayne W. Reese, Ph.D.

### John B. Watson's "Dozen Infants" Statement: A Balanced Appraisal

Chair: Martha Hübner (Universidade de São Paulo)

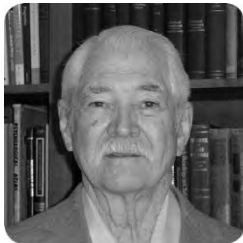

HAYNE W. REESE (West Virginia University)

Hayne W. Reese received his Ph.D. in experimental child psychology at the State University of Iowa (1958), was assistant to full professor at the State University of New York at Buffalo (1958–1967), a professor at the University of Kansas (1967–1970), and centennial professor of psychology at West Virginia University (1970–2000), at which is he now centennial professor

emeritus. His professional interests are in life-span development of learning, memory, and problem solving as well as philosophical, theoretical, and historical issues. He was a member of several National Institute of Mental Health and National Institutes of Health Initial Review Groups (for 14 years), and served the *Journal of Experimental Child Psychology* as a member of the editorial board (1965–1974, 1998–2000), associate editor (1975–1983), and editor (1983–1997). His bibliography includes dozens of authored or edited books, including 26 volumes of *Advances in Child Development and Behavior*, eight volumes of *Life-Span Developmental Psychology*, more than a hundred journal articles and chapters, and well over a hundred oral presentations.

**Abstract:** John B. Watson endorsed his “Dozen Infants” statement, and it is probably his most widely cited fragment. However, it often has been disparaged imprudently due to ignoring its context and other reasons shown by analyses in this paper. A byproduct of the analyses is a summary of the essentials of Watson’s behaviorism.

## # 55 Paper Session

---

8:30 am–9:50 am

Yucatan IV (Fiesta Americana)

AUT

### **Effective Supervision: Why, How, and Where to Do It**

Chair: Ann B. Beirne (Global Autism Project)

**Characteristics of Effective Supervision** (Applied Behavior Analysis) ANN B. BEIRNE (Global Autism Project)

**The Right Tool for the Job: Making Use of Technology in Supervision** (Applied Behavior Analysis) MOLLY OLA PINNEY (Global Autism Project)

**Ethical Supervision Around the World: Addressing the Challenges of Remote Supervision** (Applied Behavior Analysis) ANN B. BEIRNE (Global Autism Project)

## # 56 Paper Session

---

8:30 am–9:50 am

Yucatan III (Fiesta Americana)

CSE

### **Ecological Behavior and a Culturally Sensitive Approach**

Chair: Corinne M. Murphy (West Chester University)

**Respect the Earth Behavior Strategies for Fomenting Pro-ecological Behavior** (Theory) ANDREE FLEMING-HOLLAND, Esperanza Ferrant-Jimenez, and Marco Wilfredo Salas-Martínez (Universidad Veracruzana)

**Culturally Relevant Education: Applications of Discrete Trial Instruction in Multidisability Education Setting on the Island of Eleuthera** (Service Delivery) CORINNE M. MURPHY and Claire Verden (West Chester University)

**Respect. Listen. Learn. A Culturally Sensitive Approach to Supporting Families in Applied Behaviour Analysis** (ABA) (Service Delivery) DIANNA HIU YAN YIP (P.L.A.I. Behaviour Consulting)

## # 57 Paper Session

---

8:30 am–9:50 am

Salon Mérida (Fiesta Americana)

TBA

### **Challenges in Teaching Behavior Analysis to Clients and Students**

Chair: Travis Thompson (University of Minnesota)

**Teaching ABA to Front-Line Staff in Neuropsychiatry—Key Strategies and Long-Term Outcomes** (Applied Behavior Analysis) MARY ROBERTA HOADLEY (Parley Services Limited)

**Supporting Parents and Families of Children on the Autism Spectrum** (Service Delivery) JONATHAN SAILER and James Rechs (Rochester Center for Autism)

**Why Some Parents Are Reluctant ABA Partners** (Applied Behavior Analysis) TRAVIS THOMPSON (University of Minnesota)

---

### # 58 Paper Session

8:30 am–9:50 am

Izamal (Fiesta Americana)

TPC

#### **Social and Novel Behavior: Conceptual and Empirical Studies**

Chair: Marcelo Frota Benvenuti (USP)

**Research on Social Skills in Interlocking Behavioral Contingencies: The Case of Young Offenders' Families** (Applied Behavior Analysis) FABIANE FERRAZ SILVEIRA FOGACA (Universidade Federal de São Carlos), Marcelo Benvenuti Frota (Universidade de São Paulo), and Almir Del Prette and Zilda Del Prette Pereira (Universidade Federal de São Carlos)

**Social Behavior and the Analysis of Psychological Phenomena** (Theory) MARCELO FROTA BENVENUTI (Universidade de São Paulo)

**Creativity: A No Man's Land** (Theory) MARIA ISABEL MUNOZ BLANCO and Linda J. Parrott Hayes (University of Nevada, Reno)

---

### # 59 Invited Presenter

9:30 am–10:20 am

Yucatan II (Fiesta Americana)

EAB; Experimental Analysis

PSY/BACB CE Offered. CE Instructor: Ricardo Pellón, Ph.D.

#### **Empirical Support for an Operant Theory of Adjunctive Behavior**

Chair: Martha Hübner (Universidade de São Paulo)



RICARDO PELLÓN (Universidad Nacional de Educación a Distancia)

Ricardo Pellón earned a degree in psychology in 1980 and in 1987 presented his Ph.D. in experimental psychology, both at Universidad Autónoma de Madrid (Spain). He has held research positions at the University of Wales College of Cardiff, United Kingdom (1981–1984) and the Addiction

Research Centre of the National Institute on Drug Abuse, Baltimore, MD, (1990–1991). In 2005–2006, he spent a sabbatical at Arizona State University. He is currently a professor of psychology at Universidad Nacional de Educación a Distancia in Madrid, where he directs an animal behavior lab working predominantly (but not exclusively) on animal models of excessive behavior, such as schedule-induced polydipsia and activity-based anorexia, both using laboratory rats as

experimental subjects. He has published in international journals in the areas of learning and behavior, behavioral pharmacology, and neural substrates of behavior.

**Abstract:** Killeen and Pellón (2013) have developed a model that is based on the hypothesis that adjunctive behavior is maintained by delayed reinforcement, occurring despite the absence of any programmed contingency between the behavior and the consequence. The best studied example of adjunctive behavior is schedule-induced polydipsia (SIP), and here data are presented that support the idea that SIP can be maintained by reinforcement. In a first study, rats developed high levels of adjunctive drinking by delivering a pellet of food 30 seconds after the completion of 20 licks to a water-bottle spout. The acquisition of adjunctive drinking was greater than in a group that had such positive contingency on only half of the trials, and even greater than in a yoked-control group that received the food pellets irrespective of its own licking. In a second study, by default a single pellet of food was delivered at regular 90-second intervals, but the inter-food interval could be shortened depending on the rats' licking. The degree of contingency between licking the bottle spout and hastening the delivery of the food pellet was 100%, 50% and 0% for separate groups, with the development of SIP positively related to those different contingencies. Drinking is decreased if it forestalls reinforcement, enhanced if it hastens reinforcement, and can do so at delay characteristic of those present in studies of SIP. We are currently complementing these studies by testing the idea that water might derive reinforcing properties through its association with food.

#### **# 60 Paper Session**

---

10:00 am–10:20 am

Yucatan III (Fiesta Americana)

CBM

#### **Cognitive Behavior Therapy and Therapeutic Change**

Chair: Andree Fleming-Holland (Universidad Veracruzana)

**Cognitive Behavior Therapy and Therapeutic Change** (Theory) ANDREE FLEMING-HOLLAND, Marco Wilfredo Salas-Martínez, and Esperanza Ferrant-Jimenez (Universidad Veracruzana)

#### **# 61 Invited Presenter**

---

11:00 am–11:50 am

Yucatan II (Fiesta Americana)

OBM; Theory

PSY/BACB CE Offered. CE Instructor: Maria E. Malott, Ph.D.

#### **Synergy of Repertoires and Metacontingencies: An Account of the Mexican Muralist Movement**

Chair: Martha Hübner (Universidade de São Paulo)



MARIA E. MALOTT (Association for Behavior Analysis International)

Dr. Maria E. Malott is CEO of the Association for Behavior Analysis International (ABAI), which she has administered since 1993. During this time and within a few short years, ABAI has risen from near-bankruptcy to become a financially stable, growing scientific and professional organization. Her past experience includes serving as vice president of manufacturing at a Midwestern injection molding company and president and founder of Malott and Associates, through which for 14 years she consulted for advertising agencies, restaurants, retail and manufacturing companies, hotels, banks, governmental organizations, and nonprofit institutions. Her clients have included Meijer, Inc.; Kellogg's; Pharmacia & Upjohn; General Motors Corp.; and others. Throughout her career, Dr. Malott has combined the analysis of metacontingencies and behavioral contingencies in managing complex systems and, in the process, has taught dozens of corporate executives to appreciate the power of organizational behavior management technology. Dr. Malott has presented nearly 200 papers, taught 34 workshops, and lectured in 37 universities in 18 countries, and is an affiliated faculty in three universities. She has served on four editorial boards and is the author of the book *Paradox of Organizational Change*, published in Spanish and English and co-author of *Elementary Principles of Behavior*. She is a Fellow of ABAI and was the recipient of the 2003 Award for International Dissemination of Behavior Analysis from the Society for the Advancement of Behavior Analysis, the 2004 Award for Outstanding Contributions to Organizational Behavior Management from the Organizational Behavior Management Network, the 2002 Outstanding Alumni Award from the Department of Psychology at Western Michigan University, and the 2012 Award for Distinguished Service to Behavior Analysis from the Society for the Advancement of Behavior Analysis.

**Abstract:** From 1921 to the mid-1950s, the largest muralist movement in art history since the Renaissance developed in Mexico, leaving a remarkable legacy to the country and the world. The movement was controversial from its inception. It centered on an effort to create an egalitarian society; its mission was to reach the masses with expressions of their social, emotional, and political circumstances. Mexican muralists received commissions abroad and their international success brought high demand for frescoes in government and private walls around the country. The Mexican muralist movement can be analyzed as a cultural phenomenon. How did it come to exist? What kept it going and caused it to cease? And why, in spite of international attempts, did it never reach comparable scale or significance elsewhere? Dr. Malott will argue the synergy of interactions from a few individuals with distinctive repertoires and interlocking metacontingencies can account for the movement and that although the specifics of the muralists' undertakings were unique and nonreplicable, the properties of other cultural phenomena with substantial impact are of similar nature.

## # 62 Symposium

---

11:00 am–12:20 pm

Gran Salon II (Presidente Intercontinental)

CSE/CBM; Applied Behavior Analysis

### **Challenges of Training, Research and Clinical Application of Behavioral Intervention Programs in Non-English Environments**

Chair: Melina Rivard (Université du Québec à Montréal)

**Successes and Challenges in the Implementation of EIBI Services in Quebec** SYLVIE DONAIS (Clinique ABA) and Melina Rivard (Université du Québec à Montréal)

**Bringing the Early Start Denver Model to Non-English Speaking Environments** GISELA REGLI (QcABA Canada) and Melina Rivard (Université du Québec à Montréal)

**Challenges in Formation and Research for ABA Treatments in France** VINCA RIVIERE (University of Lille III)

**Successes and Challenges in the Implementation of ABA Treatments in France** MELISSA BECQUET (Universite Lille Nord de France)

## # 63 Symposium

---

11:00 am–12:20 pm

Salon Celestun (Fiesta Americana)

DDA/CSE; Applied Behavior Analysis

BACB CE Offered. CE Instructor: Jennifer R. Zarcone, Ph.D.

### **Current Research on Staff and Patient Behavior at the Kennedy Krieger Institute's Neurobehavioral Unit**

Chair: Ethan S. Long (Virginia Institute of Autism)

**The Inpatient Neurobehavioral Unit** PATRICIA F. KURTZ, Lynn G. Bowman, Jennifer R. Zarcone, and Louis P. Hagopian (Kennedy Krieger Institute)

**Increasing Staff Hand Washing in a Hospital Setting** LYNN G. BOWMAN and Samantha Hardesty (Kennedy Krieger Institute), Melissa M. McIvor Shulleeta (Behavior Change, Inc), Louis P. Hagopian (Kennedy Krieger Institute), and Sigurdur Oli Sigurdsson (University of Maryland, Baltimore County)

**The Safety of Functional Analyses of Self-Injurious Behavior** SUNGWOO KAHNG, Nicole Lynn Hausman, Alyssa Fisher, Jeanne M. Donaldson, Jessica Cox, Monica Lugo, and Katie Wiskow (Kennedy Krieger Institute)

**Measuring the Complexity of Treatment Using the Treatment Intensity Rating Form** JENNIFER R. ZARCONI, Nicole Lynn Hausman, Cara L. Phillips, and Louis P. Hagopian (Kennedy Krieger Institute)

## # 64 Symposium

*Presented in Spanish*

---

11:00 am–12:20 pm

Yucatan IV (Fiesta Americana)

EAB/DEV; Experimental Analysis

BACB CE Offered. CE Instructor: Agustin Daniel Gómez Fuentes, Ph.D.

### **Analysis of Human Conditional Discrimination**

Chair: Agustin Daniel Gómez Fuentes (Universidad Veracruzana)

**Conceptual Training and Its Effect on Extradimensional Transference** MARIA ELENA RODRIGUEZ PEREZ and Angelica Nuño Frago (Universidad de Guadalajara)

**Direct Training, Modeling, and Rule-Following Using Conditional Discrimination** LUIS HERNANDO SILVA CASTILLO, Milton Andres Miranda Herrera, and Maria Elena Rodríguez Pérez (Universidad de Guadalajara)

**Kind of Contingencies and Transfer of Matching-to-Sample Performance in Human Adults** EDGAR EDUARDO MONTES CASTRO (Universidad de Guadalajara) and Mario Serrano (Universidad Veracruzana)

**Habilitation of an Active Linguistic Mode Under Different Reactive Linguistic Modes** GELACIO GUZMAN DIAZ, Agustin Daniel Gómez Fuentes, Mario Serrano, Enoc Obed De la Sancha Villa, and Zaira Jacqueline García Pérez (Universidad Veracruzana)

## # 65 Symposium

*Presented in Spanish*

---

11:00 am–12:20 pm

Izamal (Fiesta Americana)

TPC/EAB; Applied Behavior Analysis

### **La Generacion del Conocimiento en Psicologia, de la Investigacion Basica a su Aplicacion Escenarios Naturales**

Chair: Francisco J. Pedroza-Cabrera (Universidad Autónoma de Aguascalientes)

**Sobre el Traslado de la Ciencia Conductual a la Accion: Contribuciones Para el Bienestar Social** CARLOS SANTOYO (Universidad Nacional Autónoma de México)

**Investigación Traslacional y Transferencia del Conocimiento en Psicología** FRANCISCO J. PEDROZA-CABRERA and Kalina Isela Martínez Martínez (Universidad Autónoma de Aguascalientes)

**El Proceso de Transferencia y Reinencion de las Intervenciones Breves a las Instituciones del Ambito de las Adicciones** KALINA ISELA MARTÍNEZ MARTÍNEZ (Universidad Autónoma de Aguascalientes) and María Elena Teresa Medina-Mora Icaza (Instituto Nacional de Psiquiatría)

**Barreras del Terapeuta en el Uso de Manuales: Transferencia del Conocimiento en las Adicciones** MIRIAM ILIANA VELIZ SALAZAR and Kalina Isela Martínez Martínez (Universidad Autónoma de Aguascalientes) and Ayme Yolanda Pacheco Trejo (Universidad Modelo)



## # 66 Symposium

*Presented in Spanish*

---

11:00 am–12:20 pm

Yucatan III (Fiesta Americana)

EAB; Experimental Analysis

### **Mexican Network for Research on Animal Behavior II**

Chair: Mario Serrano (Universidad Veracruzana)

**Associative Learning: Neural and Cognitive Mechanisms** LIVIA SÁNCHEZ CARRASCO (Universidad Nacional Autónoma de México)

**The Role of Secondary Rewards on Self-Control** RODRIGO SOSA and Cristiano Dos Santos (Universidad de Guadalajara)

**Serial Recall Functions in Rats** J. C. PEDRO ARRIAGA-RAMIREZ, Guadalupe Ortega-Saavedra, Ángela María Hermosillo-García, and Sara E. Cruz-Morales (Universidad Nacional Autónoma de México)

**Activity in the Running Wheel: Operant or Adjunctive Behavior?** CARLOS FLORES (Universidad de Guadalajara) and Rebeca Mateos Morfín (Universidad del Valle de México, Zapopan)

## # 67 Paper Session

---

11:00 am–12:20 pm

Salon Mérida (Fiesta Americana)

EDC

### **Technology, Education, and Behavior Analysis**

Chair: Janet S. Twyman (University of Massachusetts Medical School)

**Improving Students' Spanish Reading Fluency: Research and Development of the Leamos Para Avanzar Program** (Service Delivery) JOHN C. BEGENY and Helen Herrera (North Carolina State University) and Catalina Aguirre-Burneo (Universidad San Francisco de Quito)

**Research Accelerator: An Online Platform for Dynamic Engagement of Autism Therapy Based in Applied Behavior Analysis** (Service Delivery) DEBORAH LEE SAFKO (Infinite Personal Possibilities, Inc.)

**Technologies of Teaching and Learning I: Technology of Tools** (Applied Behavior Analysis) JANET S. TWYMAN (University of Massachusetts Medical School) and T. V. Joe Layng (Mimio)

**Technologies of Teaching and Learning II: Technology of Process** (Applied Behavior Analysis) T. V. JOE LAYNG (Mimio) and Janet S. Twyman (University of Massachusetts Medical School)

## # 68 Invited Presenter

---

12:00 pm–12:50 pm

Yucatan II (Fiesta Americana)

TPC; Theory

PSY/BACB CE Offered. CE Instructor: M. Jackson Marr, Ph.D.

### Where There's the Most Light: Motivation and Behavior Analysis

Chair: Martha Hübner (Universidade de São Paulo)



M. JACKSON MARR (Georgia Tech)

M. Jackson (Jack) Marr received a BS degree in 1961 from the Georgia Institute of Technology, where he studied mathematics, physics, and psychology. He received a Ph.D. in experimental psychology with a minor in physiology from the University of North Carolina at Chapel Hill in 1966. He is professor emeritus of psychology at Georgia Tech, where he has taught courses in physiology and behavior; behavioral pharmacology; and probability and statistics; and continues to teach the experimental analysis of behavior. He is one of five founding Fellows of ABAI, a Fellow of Division 25 (Behavior Analysis) of the American Psychological Association, a Federation of Associations in Behavioral & Brain Sciences Foundation honoree, past president of the Society for the Advancement of Behavior Analysis, past president of both ABAI and Division 25 of APA. He is the past editor of *Behavior and Philosophy*, and continues to serve as review editor of the *Journal of the Experimental Analysis of Behavior*, a position he has held since 1998. He also serves as the co-editor of *Revista Mexicana de Análisis de la Conducta*. He was an associate editor of the *Journal of the Experimental Analysis of Behavior* and *The Behavior Analyst*. He was experimental representative to the Executive Council of ABAI, served on the board of directors of the Society for the Quantitative Analysis of Behavior, and currently serves on the board of trustees the Cambridge Center for Behavioral Studies. He has been particularly active in the international support and development of behavior analysis in Europe, Mexico, China, and the Middle East. He was a Research Fellow in Pharmacology at Harvard Medical School, a visiting professor at the Universidad Nacional Autónoma de México, and the first eminent scholar invited to Jacksonville State University. He was a Navy contractor for Project Sanguine, and an AIEE Senior Fellow at the Naval Aerospace Medical Research Laboratory. For many years, he has been involved through National Science Foundation grants and other support in the assessment and improvement of engineering education, including engineering physics, using methods derived from the applied behavior analysis of skill acquisition and the cognitive science of problem solving. Other current research interests include dynamic systems theory, the quantitative analysis of behavior, comparative behavior analysis, and theoretical/conceptual issues in behavioral analysis.

**Abstract:** Behavior analysis is in the dark regarding quite fundamental concepts. For example, "motivation" is a topic many behavior analysts, basic and applied, have mixed feelings about despite what all the literature says on "motivational operations."

Dr. Marr will argue that behavior analysts, particularly in their treatment of reinforcement, are guilty of limited vision and in many ways are still tied to traditional motivational concepts—where apparently the light is better. He will provide a definition of motivation (and what it is not) and discuss some of the commonly studied variables said to control probabilities of action. Most behavior is controlled by consequences having little, if any, relation to motivational variables. Dr. Marr will discuss continued naïve perspectives on "conditioned reinforcement" and the positive versus negative reinforcement controversy as well as the role of the history of contingencies in establishing the actions of consequences. Dr. Marr believes our field needs to search beyond its current horizons to achieve more enlightenment.

### **# 69 Paper Session**

---

12:30 pm–1:50 pm

Yucatan IV (Fiesta Americana)

DEV

### **Addressing Development Issues in Behavior Analysis**

Chair: Martha Pelaez (Florida International University)

**Addressing Proto-SIB in Young Children** (Applied Behavior Analysis) CHATURI EDRISINHA and Theresa Estrem (St. Cloud State University)

**Behavioral Systems Approach to Child Development** (Theory) MARTHA PELAEZ (Florida International University)

**Neuropsychological Impact From Bullying Victimization During Childhood** (Theory) LORENA A. HIGHLAND ANGELUCCI and Francisco J. Pedroza-Cabrera (Universidad Autónoma de Aguascalientes)

### **# 70 Paper Session**

---

12:30 pm–1:50 pm

Gran Salon II (Presidente Intercontinental)

EAB

### **Social and Instructional Control Over Performance in Schedules of Reinforcement**

Chair: Josele Abreu-Rodrigues (Universidade de Brasília)

**The Effects of Social Control Upon Instruction Following** (Experimental Analysis) JOSELE ABREU-RODRIGUES and Murilo de Assis Alfaix Melo (Universidade de Brasília)

**Resurgence of Rule-Based Variability Patterns** (Experimental Analysis) THAISSA PONTES (Universidade de Brasília) and Jackson Scott, Kinsey Cameron, Jessie Cart, and Alliston K. Reid (Wofford College)

**The Role of False and True Instructions Upon the Sunk Cost Effect** (Experimental Analysis) MONIQUE CAMPOS and Josele Abreu-Rodrigues (Universidade de Brasília)

**Observing Responses and Serial Stimuli: From Tandem to Chainéd Schedules** (Experimental Analysis) MAYELA HERNÁNDEZ and Rogelio Escobar (Universidad Nacional Autónoma de México)

**# 71 Paper Session**

*Presented in Spanish*

---

12:30 pm–1:50 pm

Salon Mérida (Fiesta Americana)

EAB

**Aspectos Basicos, Aplicados e Conceptuais en la Analisis Conductual**

Chair: Carlos Javier Flores Aguirre (Universidad de Guadalajara)

**Effects of Shared Responses and Shared Consequences on Choice Between Individual and Social Contingencies** (Experimental Analysis) Nora Rangel (Universidad de Guadalajara), Emilio Ribes (Universidad Veracruzana) and SANTIAGO ORDOÑEZ and Lizbeth Pulido Avalos (Universidad de Guadalajara)

**Effect of Group Formation by Sex or Age on Foraging Behavior in Rats** (Experimental Analysis) FANNY TRUJILLO, Carlos Torres, and Carlos Flores Aguirre (Centro de Estudios e Investigacion en Comportamiento, Universidad de Guadalajara)

**Analisis Experimental de la Conducta Alimentaria: Evaluacion de la Influencia Social en el Consumo de Adolescentes** (Experimental Analysis) MA. DE LOS ÁNGELES VACIO (Universidad Autónoma de Aguascalientes)

**# 72 Symposium**

*Presented in Spanish*

---

12:30 pm–1:50 pm

Yucatan III (Fiesta Americana)

EDC/VRB; Experimental Analysis

**The Role of Linguistic Modes in Learning**

Chair: Carlos Ibáñez-Bernal (Universidad Veracruzana)

**Enabling Effect in Second Order Matching-to-Sample** JAIRO ERNESTO TAMAYO and Darcy Raul Martínez Montor (Universidad Veracruzana)

**Acquisition and Transfer of a First-Order Conditional Discrimination Using an Arbitrary Matching-to-Sample Task** AGUSTIN DANIEL GOMEZ FUENTES and Emilio Ribes (Universidad Veracruzana)

**Linguistic Modes Effects on Object Recognition and Identification Learning** ABRIL CORTÉS ZÚÑIGA and Carlos Ibáñez-Bernal (Universidad Veracruzana), María Amelia Reyes Seáñez (Universidad Autónoma de Chihuahua), and Abraham Manuel Ortíz Barradas (Universidad Veracruzana)

**Some Thoughts on the Functionality of Language Modes** CARLOS IBÁÑEZ-BERNAL (Universidad Veracruzana)

### # 73 Paper Session

---

12:30 pm–1:50 pm

Salon Celestun (Fiesta Americana)

OBM

#### **OBM Goes to Universities, Companies and Aircraft Crew**

Chair: Douglas Robertson (Florida International University)

**Instituting Zero Waste Programs in a University Setting** (Applied Behavior Analysis) CRISS WILHITE and Jonpaul D. Moschella (California State University, Fresno)

**Intentional Change and Shaping Executive Behavior at a Large Research University** (Applied Behavior Analysis) DOUGLAS ROBERTSON and Martha Pelaez (Florida International University)

**The Importance of Aviation Crew Resource Management Training and Application to Applied Behavior Analysis** (Applied Behavior Analysis) PATRICIA DAMMIER (Northcentral University)

### # 74 Paper Session

---

*Presented in Spanish*

12:30 pm–1:50 pm

Izamal (Fiesta Americana)

TPC

#### **Análisis Conceptual en la Psicología Interconductual**

Chair: Mario Ángel González (Universidad Veracruzana)

**Identidad Profesional o Desarrollo de Funciones de Estimulo Respuesta: Una Reflexión Conceptual** (Theory) MARIO ÁNGEL GONZÁLEZ and Julio Agustín Varela Barraza (Universidad de Guadalajara), Francisco Javier Pedroza-Cabrera (Universidad Autónoma de Aguascalientes), Roberto Oropeza Tena (Universidad Michoacana de San Nicolás de Hidalgo), and Cecilia Colunga Rodríguez (Universidad de Guadalajara)

**Reflexiones Críticas Sobre el Concepto de Comportamiento Inteligente de la Psicología Interconductual** (Theory) CHRISTIAN AARON CRUZ CRUZ, Veronica Luna Hernández, Winter Edgar Reyna Cruz, Alejandro Cerón Martínez, and Leslie Valeria Briseño Zamora (Universidad Nacional Autónoma de México)

**Análisis de los Usos de la Noción de Criterio de Ajuste** (Theory) ALEJANDRO CERON MARTÍNEZ, Christian Cruz, Veronica Luna Hernández, Winter Edgar Reyna Cruz, and Leslie Valeria Briseño Zamora (Universidad Nacional Autónoma de México)

**La "Noción" de Tarea en el Modelo de Interacción Didáctica: Un Análisis Conceptual** (Theory) WINTER EDGAR REYNA CRUZ, Leslie Valeria Briseño Zamora, Alejandro Cerón Martínez, Veronica Luna Hernández, and Christian Cruz (Universidad Nacional Autónoma de México)

## # 75 Invited Presenter

---

1:00 pm–1:50 pm

Yucatan II (Fiesta Americana)

TBA; Applied Behavior Analysis

PSY/BACB CE Offered. CE Instructor: Joseph J. Pear, Ph.D.

### **Behavioral Approaches to Education and Instruction**

Chair: Martha Hübner (Universidade de São Paulo)



JOSEPH J. PEAR (University of Manitoba)

Joseph J. Pear received a BS degree from the University of Maryland and MA and Ph.D. degrees from The Ohio State University. He is currently a professor of psychology at the University of Manitoba. Pear has done basic and applied research and is a Fellow of Division 6 (Behavioral Neuroscience and Comparative Psychology) and Division 25 (Behavior Analysis) of the APA. Pear's early basic research was with rats and pigeons. Currently, he is conducting research with fish using a tracking system he developed. His best-known basic research deals with behavioral contrast, shaping, and the spatio-temporal analysis of behavior. In addition, he has done work in the mathematical analysis of behavior. His early applied work focused on children with developmental disabilities at the St. Amant Centre, where he founded the Behaviour Modification Unit, now the Psychology Department. In 2009, he received an award for Outstanding Contribution to Behavior Analysis in Manitoba from the Manitoba Association for Behavior Analysis. Currently, he is the principal investigator on a grant to research knowledge transfer with members of the psychology departments at the University of Manitoba and Brock University, and with researchers at St. Amant and the New Haven Learning Centre in Ontario. Pear also developed an instructional and research program called Computer-Aided Personal System of Instruction (CAPSI). CAPSI is used to teach courses at the University of Manitoba and at other universities in Canada, the United States, and Australia. For his work in this area, Pear received two honors: An award for Innovative Excellence in Teaching, Learning, and Technology at the 13th International Conference on Teaching and Learning and the Fred S. Keller Behavioral Education Award for Distinguished Contributions to Education from Division 25 of the APA. In addition to co-authoring *Behavior Modification: What It Is and How to Do It* with Garry Martin, Pear has written two other books: *The Science of Learning* and *A Historical and Contemporary Look at Psychological Systems*. He also has written numerous basic and applied research articles, book chapters, and encyclopedia articles.

**Abstract:** Throughout the history of psychology, interest has been strong in applying it to education and instruction. This interest increased as focus shifted to the influence of the environment on behavior with the rise of functionalism and behaviorism. This presentation will look at this trend starting with the founder of modern psychology, William James, who was skeptical of psychology's ability to be applied to education. It will then discuss John Dewey, who turned James's view on its head by applying his

pragmatic and functional philosophy to education through the dictum of "learning by doing;" Edward L. Thorndike, who applied his studies on learning to education without admitting to being a behaviorist; Sidney L. Pressey and B. F. Skinner, who with their respective teaching machines led the way toward programmed learning systems; and onto Fred S. Keller, whose personalized system of instruction (PSI) said "goodbye" to old-style teaching and laid the groundwork for a new role for educators as contingency managers or arrangers of learning-promoting environments. The presentation will then discuss two contemporary behavioral approaches: interteaching and CAPSI, both of which stem from the work of Skinner and Keller.

### **# 76 Paper Session**

*Presented in Spanish*

---

2:00 pm–3:20 pm

Salon Mérida (Fiesta Americana)

EAB

### **Associative Learning: Principles and Applications**

Chair: Javier Nieto Gutierrez (Universidad Nacional Autónoma de México)

**An Experimental Task to Study Human Episodic Like Memory** (Experimental Analysis) ENEIDA STREMLER, Angélica Alvarado, and Javier Vila (Facultad de Estudios Superiores Iztacala, Universidad Nacional Autónoma de México)

**Renewal Effect on a Spatial Search Task With Simultaneous Interference** (Experimental Analysis) DAVID LUNA, Alberto Monroy, and Javier Vila (Facultad de Estudios Superiores Iztacala, Universidad Nacional Autónoma de México)

**An Extinction Cue Attenuates the Retrieval of Operant Responses** (Experimental Analysis) ALEXIS MARTÍNEZ RAMÍREZ, Gabriela Cruz, Rodolfo Bernal, and Javier Nieto Gutierrez (Universidad Nacional Autónoma de México)

**Effects of Spacing Extinction Sessions on the Renewal of Operant Responses** (Experimental Analysis) MONTSERRAT CARRASCO LÓPEZ, Ximena Salinas Hernández, Rodolfo Bernal, and Javier Nieto Gutierrez (Universidad Nacional Autónoma de México)

### **# 77 Paper Session**

2:00 pm–3:20 pm

Gran Salon II (Presidente Intercontinental)

EAB

### **Delayed Reinforcement, Behavioral History and Resurgence**

Chair: Josele Abreu-Rodrigues (Universidade de Brasília)

**The Effects of Behavioral History on Response Acquisition With Delayed Reinforcement: A Parametric Analysis** (Experimental Analysis) MARCO PULIDO (Universidad Intercontinental)

**Resurgence of Response Sequence** (Experimental Analysis) JOSELE ABREU-RODRIGUES, Thaissa Pontes, Amanda Miranda, and Lucas Tonhá (Universidade de Brasília)

**Effects of Response-Signal Temporal Separation on Behavior Maintained by Delayed Reinforcement: A Parametric Analysis** (Experimental Analysis) MARCO PULIDO (Universidad Intercontinental)

---

### # 78 Paper Session

2:00 pm–3:20 pm

Yucatan IV (Fiesta Americana)

EAB

### Research With Implications for Technology

Chair: María Antonia Padilla Vargas (Universidad de Guadalajara)

**Evaluation and Teaching of Pre-arithmetical Abilities Using Stimulus Control Technology** (Experimental Analysis) JOÃO CARMO DOS SANTOS, Janaina Caneguim, and Rogério Crevelenti Fioraneli (Universidade Federal de São Carlos)

**Effects of Varying the Characteristics of Referential Texts on Reading and Writing Scientific Texts** (Experimental Analysis) MARÍA ANTONIA PADILLA VARGAS and Josué González Díaz (Universidad de Guadalajara)

**On the Dynamics of Stimulus Control During Guided Skill Learning** (Experimental Analysis) ALLISTON K. REID (Wofford College)

---

### # 79 Symposium

2:00 pm–3:20 pm

Yucatan III (Fiesta Americana)

EAB; Experimental Analysis

### When Bad Things Happen to Good Environments: Incorporating Aversive Events Into Translational Laboratory Models

Chair: Raymond C. Pitts (University of North Carolina Wilmington)

**Investigation of Some Familiar and Not-so-Familiar "Punishers"** CHRISTINE E. HUGHES, Billie J. Klein, Cassandra Lynn Stem, and Raymond C. Pitts (University of North Carolina Wilmington)

**Beyond Delay Discounting: Expanding Laboratory Models of Self-Control to Include Aversive Events** MICHAEL PERONE and Aaron Dumas (West Virginia University)

**Stimulus Equivalence and Class-Specific Consequences: Can "Negative" Elements of the Reinforcement Contingency Produce Equivalence Relations?** CAROL PILGRIM and Breyanna Marie Long (University of North Carolina Wilmington)

**Laboratory Models of Challenging Behaviors During Transitions** DEAN C. WILLIAMS and Kathryn Saunders (University of Kansas)



## # 80 Paper Session

*Presented in Spanish*

---

2:00 pm–3:20 pm

Salon Celestun (Fiesta Americana)

PRA

### **Positive Behavior Practices: Reducing Severe Behaviors Without the Use of Punishment Contingencies**

Chair: Deysi Zendejas (Institute for Applied Behavior Analysis)

**Effective Practices for Children With Challenging Behavior: Using Positive Behavior Support** (Applied Behavior Analysis) SONIA VENEGAS, Gary W. LaVigna, Thomas J. Willis, and Elizabeth Hughes (Institute for Applied Behavior Analysis)

**Case Study: Positive Behavior Practices for the Reduction of Self-Injury and Aggression in a Specialized Setting** (Applied Behavior Analysis) LAURA HERNANDEZ, Elizabeth Hughes, and Kristin Mendelsohn-Troy (Institute for Applied Behavior Analysis)

**Positive Behavior Practices Training: Effects on Special Education Staff Self-Efficacy, ABA Knowledge, and Intervention Design** (Applied Behavior Analysis) ELENA HUERTA and Elizabeth Hughes (Institute for Applied Behavior Analysis)

## # 81 Invited Panel

---

2:00 pm–3:20 pm

Yucatan II (Fiesta Americana)

TPC; Theory

PSY/BACB CE Offered. CE Instructor: Linda J. Parrott Hayes, Ph.D.

### **Pioneers of Behavior Analysis Looking at the Future**

Chair: Martha Hübner (Universidade de São Paulo)

JOÃO CLAUDIO TODOROV (Universidade de Brasília)

RICHARD W. MALOTT (Western Michigan University)

LINDA J. PARROTT HAYES (University of Nevada, Reno)



Dr. João Claudio Todorov was born in Santo Anastácio, São Paulo, Brazil, on June 8, 1941. He finished his undergraduate studies in psychology at the University of São Paulo in 1963. While attending the master's program in psychology at the University of Brasília, he was a teaching assistant in the new Personalized System of Instruction (PSI) teaching method working with Fred Keller. In 1965, he was admitted to the graduate program in psychology at

Arizona State University, continuing the work in PSI with Keller and Gil Sherman. From January to July of 1968, he was a research assistant at the Institute for Behavioral Research in Silver Spring, MD. During the academic year 1968–1969, he was assistant professor of psychology at the University of Virginia. Todorov received his Ph.D. in 1969 and was hired by the University of São Paulo Medical School in Ribeirão Preto, São Paulo, Brazil. In 1973, he returned to the University of Brasília, retiring in 2000. In 1977, he was a visiting professor at the Universidad Nacional

Autonoma de México, and in 1990–1991 he was a Fulbright Scholar at Stony Brook University. He was dean of graduate studies and research (1985), vice president (1985–1989), and president (1993–1997) of the University of Brasília, Brazil.



Dr. Richard Malott, with more than 40 years of experience at Western Michigan University, has used the principles of behavior to construct teaching models and behavioral systems that have been sustained for several decades. As a result, he has taught generations of students to use behavior analysis in their everyday lives as learners, teachers, practitioners, and citizens, and has provided the training grounds for many of the field's leaders in behavioral systems design. Dr. Malott is a prolific, creative, and engaging writer who has authored some of the field's most important and widely read publications, including *Elementary Principles of Behavior* (first with Donald Whaley and then with Maria E. Malott and Elizabeth Trojan Suarez), which is in its sixth edition. His innovative use of multimedia has captivated audiences for decades. He helped found what would become ABAI and has been instrumental in its survival, growth, and vitality. Dr. Malott's many contributions include establishing ABAI's Teaching Behavior Analysis SIG and its Education Board. His sense of humor, self-deprecating style, and willingness to push the envelope have made him an iconic figure in the behavior analytic community.



Linda J. Parrott Hayes is a distinguished international professor at the University of Nevada, Reno (UNR). She received her bachelor's degree from the University of Manitoba in Canada and her master's and doctoral degrees from Western Michigan University. She was a member of the behavior analysis faculty at West Virginia University while completing her doctoral degree, after which she returned to Canada, taking a position at St. Mary's University. In 1990, Dr. Hayes co-founded the Behavior Analysis Program in the Psychology Department at UNR, on a self-capitalization model and served as its director for more than a decade. She also founded and directs UNR's satellite programs in behavior analysis. She has been actively involved in the development of behavior analysis around the world, her efforts having been central to the development of a graduate program in behavior analysis at the Jordan University of Science and Technology. Dr. Hayes is a Fellow of ABAI and has held a number of leadership positions in ABAI, including its presidency and as coordinator of its education and practice boards. Her scholarly work reflects a wide range of interests though she is best known for her work in the areas of behavior theory and philosophy.

**Abstract:** The field of behavior analysis is at a critical state of development with growth, challenges, and opportunities facing all of us: scientists, educators, and practitioners. In this panel, pioneers in behavior analysis from around the world share their perspectives regarding the single-most important effort we can make today to preserve the integrity of the science and application in an evolving discipline.

## # 82 Paper Session

---

2:00 pm–2:50 pm

Izamal (Fiesta Americana)

VRB

### **Boring, Skinner, and Kantor**

Chair: Mitch Fryling (California State University, Los Angeles)

**A Unifying Taxonomy of Verbal Behavior** (Theory) AIKATERINI DOUNAVI  
(Queen's University of Belfast)

**J. R. Kantor's Psychological Linguistics** (Theory) MITCH FRYLING (California  
State University, Los Angeles)

## # 83 Special Event

---

3:30 pm–4:00 pm

Yucatan I (Fiesta Americana)

### **Closing Celebration**

Chair: Martha Hübner (Universidade de São Paulo)

Please join us in celebration as we say goodbye to colleagues and friends, old and new. Martha Hübner, international representative to the ABAI Council and chair of the Program Committee, will make brief concluding remarks on the future of behavior analysis in Mexico and around the world. We will conclude with a short musical performance, as we leave Mérida and turn our thoughts toward the Eighth International Conference in Japan in 2015.

# **ABATEC**

**Applied Behavior Analysis:  
Training, Education, and Consultation**

*Ofrecemos Servicios de Terapias ABA,  
Adiestramiento, y Consultoría en la comunidad hispana  
en Estados Unidos y países de habla hispana.*

*Para más información: [abatec.org](http://abatec.org)*

## Primary Area Index

### **AAB: Applied Animal Behavior**

2, 46

### **AUT: Autism**

3, 4, 5, 6, 13, 20, 52, 53, 55

### **BPH: Behavioral Pharmacology**

39

### **CBM: Clinical; Family; Behavioral Medicine**

14, 21, 27, 35, 47, 60

### **CSE: Community Interventions; Social and Ethical Issues**

22, 26, 44, 56, 62

### **DDA: Developmental Disabilities**

51, 63

### **DEV: Human Development**

48, 69

### **EAB: Experimental Analysis of Behavior**

7, 12, 15, 16, 23, 24, 28, 29, 30, 31, 36, 38, 40, 59, 64, 65, 66, 70, 71, 76, 77, 78, 79

### **EDC: Education**

34, 42, 67, 72

### **OBM: Organizational Behavior Management**

8, 10, 17, 45, 61, 73

### **PRA: Practice**

49, 80

### **TBA: Teaching Behavior Analysis**

43, 57, 75

### **TPC: Theoretical, Philosophical, and Conceptual Issues**

9, 11, 18, 32, 41, 54, 58, 68, 74, 81

### **VRB: Verbal Behavior**

19, 25, 33, 37, 50, 82



The ABAI Learning Center offers online access to popular sessions from ABAI events; it allows you to listen to and view presentations and includes opportunities to earn continuing education credit for behavior analysts from selected sessions.



**learning center**  
www.abainternational.org

# Author Index

## A

---

Abreu, Paulo 50(109)  
Abreu-Rodrigues, Josele 40(7), 70, 77  
Aguilar-Salazar, Cesar 3  
Aguilera Rubalcava, San Juana 21  
Aguirre-Burneo, Catalina 67  
Akmanoglu, Nurgul 52(130)  
Al Haddad, Mona 13  
Alavosius, Mark 17  
Alfaro, Javier 29  
Allman, Melissa 20  
Almeida, João 7  
Alonso Sancho-Davila, Oderay 13  
Alvarado, Angélica 76  
Alvarado, Marisela 24, 44(89), 48(106)  
Alvarez, Monica 47(100)  
Amari, Adrianna 14  
Amd, Micah 40(10)  
Anderson, Angelika 4  
Anderson, Cynthia 35  
Andrade, Ariadna 42(82)  
Angulo, Jarume 6  
Arias, Sarai 40(52)  
Arntzen, Erik 7, 36, 40(2), 40(24), 40(25)  
Arriaga-Ramirez, J. C. Pedro 66  
Arroyo, Rosalinda 50(113)  
Arrubla, Paola 40(4)  
Assis, Grauben 40(61)  
Augland, Hanne 40(24), 40(25)  
Avila, Raul 31, 40(43)

## B

---

Babalian, Katrina 48(106)  
Bahl, Alisa 35  
Bains, Parbinder 52(122)  
Baker, Mary 20  
Ballard, Linda 14  
Barba, Mariana 29  
Barker, Shayne 23  
Barnes-Holmes, Dermot 40(10)  
Barragan, Lydia 21  
Barroso, Rodolfo 47(101)  
Batu, Sema 52(130)

Bautista, Luis 25  
Baxter, Susan 44(85)  
Bazán, Dulce 11  
Becquet, Melissa 62  
Begeny, John 42(77), 67  
Beirne, Ann 22, 55  
Bejar, Clara 47(100)  
Bejar, Francisca 47(100)  
Benvenuti, Marcelo 40(15), 40(58), 58  
Bermudez, Karina 40(60)  
Bernal, Rodolfo 76  
Berry Malmberg, Debra 44(87), 52(124)  
Bickel, Warren 23  
Bigelow, Katelin 42(77)  
Blakely, Elbert 53  
Boehr, Brendan 40(39), 41(69)  
Bordieri, Michael 40(32), 42(73)  
Bortoloti, Renato 40(54)  
Bosch, Amanda 20  
Bowman, Lynn 63  
Bowman, Whitney 40(39)  
Brandt, Andrew 30  
Briseño Zamora, Leslie Valeria 42(76),  
44(86), 44(88), 74  
Brough, Justin 20  
Bruce, Katherine 16  
Bruner, Carlos 2, 40(48), 40(60)  
Bruner, Natalie 23  
Burgos, José 40(50), 40(51)

## C

---

Cabrera, Tersita 6  
Caceres, Graciela 6, 37  
Cadena, Erika 47(101)  
Caldas, Stephanie 40(32)  
Camacho, Josue Antonio 40(52)  
Camarena, Héctor 40(18)  
Cameron, Kinsey 70  
Campos, Heloisa 16  
Campos, Monique 70  
Candido, Amber 17  
Caneguim, Janaina 78  
Caporal, Leticia 29

Carmo, João 40(13), 40(61), 42(74),  
42(75), 78  
Caron, Pier-Olivier 40(16)  
Carranza, Rodrigo 40(26)  
Carrasco, Montserrat 76  
Cart, Jessie 70  
Castañeda Mota, María Marcela 42(83)  
Castro, Tatiane 40(64)  
Cavita, Alejandra 40(57)  
Cepeda, Maria Luisa 50(113)  
Cerón Martínez, Alejandro 42(76),  
44(86), 44(88), 74  
Cervantes-Herrera, Ana 21, 40(20)  
Chainé, Silvia 47(103), 47(104), 47(105)  
Chavez, Mapy 6, 37  
Cho, Jung Yeon 52(117)  
Coffin, Norma 47(100)  
Collins, Ashley 42(77)  
Colunga, Cecilia 74  
Cooke, Caroline 4  
Cooper, Joshua 34  
Cornely, Jennifer 52(118)  
Cortés Zúñiga, Abril 72  
Cox, Jessica 63  
Crawford, Jennifer 8, 18  
Crevelenti Fioraneli, Rogério 78  
Cristiano, Liliana 40(6)  
Cruz, Christian 42(76), 44(86), 44(88), 74  
Cruz, Gabriela 76  
Cruz, José 40(56)  
Cruz-Morales, Sara 66

## D

---

Dammier, Patricia 73  
Dannevik, Margaret 42(80)  
das Graças De Souza, Deisy 7, 28, 46(96)  
Davenport, Lisa 49(107)  
De la Sancha, Enoc 33, 64  
de Lima, Lorena 40(7)  
De Los Ángeles Vacío, María 40(14), 71  
de Oliveira, Keyciane 42(72)  
de Oliveira, Lena 42(72)  
De Rose, Julio 7, 12, 28, 40(54)  
DeBernardis, Genevieve 41(67)  
Debert, Paula 16

Degenhart, Todd 47(98)  
DeGrazia, Lauren 52(118)  
Del Prette, Almir 58  
Del Prette, Zilda 58  
DeLeon, Iser 20  
Delgado, Emeth 40(50), 40(51)  
Diaz, Felipe 40(63), 40(65), 47(97)  
Domican, Lisa 4  
Donais, Sylvie 62  
Donaldson, Jeanne 63  
Dooling, Robert 40(41)  
Doran, Erica 7  
Dos Santos, Cristiano 40(47), 41(66), 66  
dos Santos, Mateus 40(64)  
Dotson, Wesley 20  
Doughty, Adam 40(49)  
Dounavi, Aikaterini 82  
Drugan, Steve 47(98)  
Dumas, Aaron 79  
Dunn, Noreen 52(122)  
Dyal, Valerie 49(108)

## E

---

Edrisinha, Chaturi 52(126), 69  
Eldar, Eitan 42(71), 42(79)  
Elliffe, Douglas 24  
Endresplass, Tom 45(93)  
Escobar, Rogelio 24, 40(9), 70  
Esparza, Natalia 27  
Espinosa-Esteban, Brenda 40(28)  
Estrem, Theresa 69

## F

---

Fagerstrøm, Asle 45(91), 45(94)  
Falkenstein, Emily 5  
Fang, Dan 20  
Ferrant-Jimenez, Esperanza 3, 42(78),  
42(81), 56, 60  
Ferrer Alarcón, Judith Elisa 47(103)  
Fields, Lanny 7, 34, 40(2)  
Finch, Amanda 52(124)  
Fisher, Alyssa 63  
Fleming, Cindy 4  
Fleming, Richard 4  
Fleming-Holland, Andree 3, 42(78), 56, 60

Flores, Araceli 21  
Flores, Carlos 15, 40(19), 40(4),  
40(42), 40(45), 66, 71  
Flores, Emmanuel 40(63)  
Flores, Maricela 40(19), 40(45)  
Fogaca, Fabiane 58  
Fonseca Leon, Luis 40(36)  
Foran, Michelle 4  
Forget, Jacques 40(16)  
Franco, Karina 47(97)  
Frank-Crawford, Michelle 20  
Frías, Betariz 47(101)  
Fryling, Mitch 82  
Fuentes González, Elia Natalia 40(30)

## G

---

Galizio, Ann 40(49)  
Galizio, Mark 16  
Gallardo, Sarahi 40(31), 40(35)  
Gaona, Yultzin 40(29), 40(33), 40(34)  
García Pérez, Zaira 64  
García Barranco, Rosa 37  
Garcia, Marcos 50(109)  
Garcia, Yors 40(6)  
García-Leal, Óscar 40(17), 40(18)  
Genc, Derya 52(127), 52(128)  
Glenn, Sigrid 17, 32, 52(119)  
Goldberg, Melissa 20  
Golfeto, Raquel 7  
Gomes, Felipe 50(109)  
Gómez Becerra, Inmaculada 37  
Gómez, Agustin Daniel 12, 40(52),  
40(55), 64, 72  
Gómez, Ivan 15  
González Díaz, Josué 78  
González, Rebeca 45(92)  
González-Beltrán, Luis 40(53)  
Goyos, A. Celso 40(64)  
Gracias, Adriana 24, 44(89), 48(106)  
Gracida, Noe 50(113)  
Granados, Dora 42(83)  
Greene, Shelley 40(32)  
Greenhaw, Rhonda 5  
Greer, R. Douglas 19  
Gualberto, Priscila 42(74)

Gudmundsson, Kristjan 82  
Guzman, Gelacio 64

## H

---

Hagopian, Louis 20, 63  
Hale, Leigh 44(85)  
Hamad, Charles 4  
Hanna, Elenice 28  
Hansen, Steffen 36  
Hantula, Donald 14, 45(94)  
Harangen, Camilla 40(24), 40(25)  
Hardesty, Samantha 63  
Harvey, Ada 53  
Hasegawa, Fukuko 46(95)  
Hausman, Nicole 63  
Hayes, Linda 41(67), 50(110), 50(111),  
58, 81  
Hebert, Emmie 40(32), 42(73)  
Heilveil, Ira 5  
Henklain, Marcelo Henrique Oliveira 42(75)  
Herguz, Jannay 25  
Hermosillo-García, Ángela 66  
Hernández, Anayeli 40(57)  
Hernández, Laura 80  
Hernández, Mayela 70  
Hernández, Sofia 25  
Hernández, Varsovia 40(48)  
Herrera, Helen 67  
Hetzroni, Orit 42(71)  
Hickman, Hortensia 50(113)  
Higgins, Nicole 40(39)  
Highland, Lorena 69  
Hillier, Kerry 4  
Hinnenkamp, Jay 16  
Hirschmann, Michal 42(71), 42(79)  
Hoadley, Mary 57  
Holth, Per 40(5)  
Houmanfar, Ramona 17  
Huber, Erik 28  
Hübner, Martha 1, 2, 9, 19, 26, 34,  
42(83a), 50(109), 54, 81, 83  
Hughes, Christine 79  
Hughes, Elizabeth 3, 80  
Hunziker, Maria 39(1), 40(59)  
Huziwara, Edson 46(96)

**I**

---

Ibáñez -Bernal, Carlos 40(56), 72

**J**

---

Jacobs, Kenneth 50(110)  
Jesus, Juliana 52(120)  
Jimenez, Lourdes 47(100)  
Johnson, Douglas 45(90)  
Johnson, Matthew 23  
Johnson, Patrick 23  
Johnston, Susan 49(107), 49(108)

**K**

---

Kahng, SungWoo 63  
Kang, KyungSook 51(114)  
Kapse, Kushal 20  
Kearns, Donna 52(121)  
Kelly, Michelle 13  
Kirkpatrick, Kimberly 23  
Klein, Billie 79  
Koffarnus, Mikhail 23  
Kresselman, Alyssa 40(49)  
Kurt, Onur 52(128)  
Kurtz, Patricia 63

**L**

---

Landim, Daniela 42(83a)  
Lang, Russell 52(126)  
LaVigna, Gary 14, 80  
Layng, T. V. Joe 67  
Lebbon, Angela 45(90)  
Lee, Sin Chien 45(90)  
Lemanek, Kathleen 47(98)  
Levy, Rebecca 42(77)  
Li, Anita 40(38), 50(112)  
Lian, Torunn 36  
Lillemoen, Maria 45(91)  
Liston, Kennan 23  
Lobo, Harold 4  
Loehman, Jessica 42(77)  
Long, Breyanna 79  
Long, Ethan 20, 35, 52(131), 63  
Lopez, Alejandra 47(104)  
López, Florente 40(31), 40(35)  
López, María 31  
Lorenz, Terry 23

Lovo Martins, Luis Antonio 50(109)  
Lugo, Monica 63  
Luna Hernández, Veronica 42(76),  
44(86), 44(88), 74  
Luna, David 76

**M**

---

Madden, Gregory 23  
Malott, Maria 17, 61  
Malott, Richard 40(3), 52(116), 81  
Manabe, Kazuchika 40(41)  
Manfredi, Rosemarie 13  
Mariana, Gaytan 40(22), 40(23)  
Markowitz, Ali 52(116)  
Marques, Natalia 40(15)  
Marr, M. Jackson 32, 68  
Marshall, Andrew 23  
Martin, Diego 40(37)  
Martin, Jessica 30  
Martinelli, Patricia 6, 22, 37  
Martínez, Alexis 76  
Martínez Martínez, Kalina 65  
Martínez Montor, Darcy Raul 72  
Mason, Lee 6  
Mateos, Rebeca 40(42), 66  
Mattaini, Mark 26, 32  
McCabe-Odri, Kathleen 52(118)  
McGee, Katrina 52(122)  
McIlvane, William 28  
McIvor, Melissa 63  
McLay, Laurie 52(125)  
Medina-Mora, Maria Elena 65  
Mejía Cruz, Diana 40(43)  
Melo, Murilo 70  
Mendez, Ileri 40(63)  
Menez, Marina 40(31), 40(35)  
Meraz, Emanuel 33  
Miccione, Mariana 40(61)  
Millau, Marie 52(123)  
Miller, Susan 52(119)  
Miralrio, Constanza 47(100)  
Miranda, Amanda 77  
Miranda, David 29  
Miranda, Milton 64  
Mobekk, Hilde 45(94)



Molina, Cecilia 40(55), 40(56)  
Monroy, Alberto 76  
Montaño, Oscar 27  
Montagnoli, Tathianna 46(96)  
Montague, P. Read 23  
Montanez, Nicolette 48(106)  
Montemayor, Allegra 6  
Montenegro, Marcos 27  
Montes, Edgar 25, 64  
Montiel, Danette 41(70), 80  
Moore, Dennis 4  
Morales Knight, Louis 35, 47(99)  
Morales, Silvia 21, 40(43)  
Moreira, Junnia 42(72)  
Moreno Rodríguez, Diana 47(101),  
50(113)  
Moriyama, Tetsumi 46(95)  
Morrell, Cresse 52(131)  
Moschella, Jonpaul 73  
Moss-Lourenco, Patricia 7  
Mounger, Stephanie 53  
Moysén, Alejandra 29  
Mudford, Oliver 24  
Mullen, Ashlyne 42(73)  
Muñiz González, Iván 47(97)  
Munoz Blanco, María 41(67), 58  
Munoz-Martínez, Amanda 27  
Murphy, Corinne 56

## **N**

---

Nakagawa, Hiroya 40(11)  
Nakajima, Sadahiko 40(11)  
Nartey, Richard 7  
Nieto Gutierrez, Javier 40(26), 40(43),  
59, 76  
Niwayama, Kazuki 52(129)  
Nogara, Thais 40(58)  
Noll, Mary 52(126)  
Norbom, Aina 40(2)  
Nuñez, Olivia 31  
Nuñez Fragoso, Angelica 40(44), 64

## **O**

---

O'Boyle, Michael 20  
O'Donnell, Ryan 40(38), 50(112)

Oliveira, Camila Straforin 40(13)  
Oliveira, Luiza 42(83a)  
Oliveira, Sabrina 7  
Ordoñez, Santiago 71  
Orduna, Vladimir 40(22), 40(23)  
O'Reilly, Mark 52(126)  
Oropeza, Roberto 74  
Ortega, Gia 8, 18, 52(132)  
Ortega-Saavedra, Guadalupe 66  
Ortíz, Abraham 72  
Ortíz, Gerardo 31, 33  
Ortíz, Martín 42(78), 42(81)

## **P**

---

Paasch, Valerie 14  
Pacheco, Ayme 65  
Padilla Vargas, María Antonia 40(46),  
40(47), 68, 75, 78  
Pagan, Jenny 53  
Park, Hyun Ok 13  
Parra, Eduardo 40(29), 40(33), 40(34)  
Partida, José 31  
Patrón, Felipe 40(40)  
Pear, Joseph 75  
Pease, Nicole 52(118)  
Pedraza, Diana 42(81)  
Pedroza-Cabrera, Francisco 21, 40(20),  
65, 69, 74  
Pelaez, Martha 69, 73  
Pellón, Ricardo 59  
Peña, Telmo 25, 33  
Peralta Guerra, Elvia 42(82)  
Pérez, Dayanth 29  
Pérez, Minerva 40(52)  
Pérez, Nara 21  
Pérez Almonacid, Ricardo 25  
Pérez Herrera, Carlos 24  
Pérez-Lopez, Alma 40(28)  
Perone, Michael 79  
Phillips, Cara 63  
Phillips, Katrina 24  
Pilgrim, Carol 79  
Pinney, Molly 22, 55  
Pitts, Raymond 79  
Plancarte, Patricia 50(113)

Pontes, Thaisa 70, 77  
Porlan de Oliveira, Thais 52(120)  
Porto, Kaíque 40(64)  
Porto, Tatiany 40(59)  
Prichard, Ashley 16  
Pritchard, Joshua 40(38), 40(39),  
41(69), 50(112)  
Pulido, Lizbeth 33, 71  
Pulido, Marco 3, 40(8), 77

## Q

---

Quebedeaux, Gina 40(32)  
Quiroga, Horacio 6  
Quiroga, Luis 40(4)

## R

---

Rangel, Margareth 25  
Rangel, Nora 33, 40(30), 40(44), 71  
Real, Gisell Anaid 40(14)  
Rechs, James 57  
Reese, Hayne 54  
Regli, Gisela 41(68), 62  
Reid, Alliston 70, 78  
Reis, Thaize 28  
Renda, Renee 23  
Resende, Xilander 52(120)  
Reyes, Geronimo 42(82)  
Reyes, María 72  
Reyna Cruz, Winter Edgar 42(76),  
44(86), 44(88), 74  
Rezende, Junio 52(120)  
Ribero, Sergio 40(6)  
Ribes, Emilio 71, 72  
Richman, David 20  
Rico, Viviane 28  
Rivard, Mélina 40(16), 41(68), 52(123), 62  
Rivera, Alejandra Monserrat 47(105)  
Riviere, Vinca 62  
Robertson, Douglas 73  
Robles, Elias 30  
Robles, Susana 47(101)  
Roca, Alicia 38, 47(102)  
Rodríguez Pérez, Maria 40(21), 40(44),  
40(62), 64  
Rodríguez, Alejandra 40(46)

Rodríguez, Belén 37  
Rodríguez, Enzo 40(17)  
Rodríguez, Kristina 42(77)  
Rodríguez Ferrari, Maria Belen 6  
Rodríguez, Martha 47(101)  
Rolim, Sidinei 50(109)  
Romo, Mauricio 40(21)  
Ruíz Casteñeda, Dyanne 37  
Ruíz, Viridiana 50(113)  
Rutherford, Tanya 44(87), 52(124)  
Ryan, Rebecca 8, 18  
Rzemyk, Nicole 52(118)

## S

---

Safko, Deborah 67  
Sailer, Jonathan 57  
Salas-Martínez, Marco 3, 42(78),  
42(81), 56, 60  
Salazar, Jovany 40(37)  
Salazar, Martha 40(14)  
Salinas, Ximena 40(37), 76  
Salvi, Silvina 35, 47(99)  
Salzinger, Kurt 9, 61  
Sanberg, Sela 35, 47(99)  
Sánchez Hernández, María 40(55)  
Sánchez Carasco, Livia 40(26), 40(28),  
40(29), 40(33), 40(34), 40(37), 66  
Sandaker, Ingunn 32, 45(93)  
Sandoz, Emily 40(32), 42(73)  
Santillán, Nadia 40(9)  
Santoyo, Carlos 40(53), 65  
Saunders, Kathryn 40(49), 79  
Scott, Jackson 70  
Serna, Richard 4  
Serrano, Mario 15, 31, 64, 66  
Sharp, Rebecca 24  
Sigafos, Jeffrey 52(125)  
Sigurdsson, Sigurdur 63  
Silva, Luis 64  
Silva, Rafael 52(120)  
Slifer, Keith 14  
Smith, Cath 44(85)  
Smith, Mallory 52(132)  
Smith, Timothy 47(98)  
Solheim, Mari 45(93)

Sosa, Rodrigo 40(8), 41(66), 66  
Spear, Jack 34  
Stebbing, Simon 44(85)  
Stedham, Dominique 50(111)  
Stein, Jeffrey 23  
Steingrimsdottir, Hanna Steinunn 36  
Stem, Cassandra 79  
Strempler, Eneida 76  
Sutherland, Dean 52(125)  
Swisher, Melissa 16

## **T**

---

Takaku, Shinichi 40(41)  
Tamayo, Jairo 72  
Tanaka-Matsumi, Junko 52(129)  
Tekin-Iftar, Elif 52(128)  
Thommen, Rany 8, 18  
Thompson, Travis 57  
Tipu, Ofelia 52(126)  
Todorov, João 32, 81  
Tonhá, Lucas 77  
Torres, Alvaro 40(12)  
Torres, Carlos 15, 31, 40(30), 71  
Torres, Gerardo 40(47)  
Torres, Omar 42(78)  
Tovar, Angel 40(12)  
Treharne, Gareth 44(85)  
Trujillo, Fanny 71  
Tsuen, Ho Yan 42(77)  
Twyman, Janet 67  
Tybor, Marissa 43(84)

## **U**

---

Urcuioli, Peter 16

## **V**

---

Vaidya, Manish 16  
Valadez, Alejandra 40(29), 40(33), 40(34)  
Valença, Isis 42(72)

Valle Salazar, María 40(62)  
Van der Meer, Larah 52(125)  
Varela, Julio 74  
Vargas, Maricruz 40(22), 40(23)  
Vega, Cristina 24, 44(89), 48(106)  
Velázquez González, Gabriel 15, 40(19),  
40(45)  
Veliz, Miriam 65  
Venegas, Sonia 80  
Verden, Claire 56  
VerLee, Sarah 47(98)  
Vie, Aleksander 36  
Vila, Javier 76  
Vilardo, Brigid 35, 47(99)  
Villamil, Carlos 40(4)  
Vite, Ariel 29, 40(57)  
Vogel, James 44(87)  
Von Witzleben, Mary 51(115)

## **W**

---

Wallace, Michele 24, 44(89)  
Wang, Daisy 52(122)  
Warzak, William 35, 47(99)  
Weatherly, Jeffrey 30  
Wesley, Michael 23  
Wilhite, Criss 73  
Williams, Dean 40(49), 79  
Wiskow, Katie 63

## **Y**

---

Yaber, Guillermo 10  
Yanardag, Mehmet 52(130)  
Yateem, Sharifa 13  
Yip, Dianna 52(122), 56  
Yucesoy Ozkan, Serife 52(127)

## **Z**

---

Zarccone, Jennifer 63  
Zepeta, Enrique 40(52), 40(55), 40(56)

# Seventh International Conference Floor Plan

## Floor 1

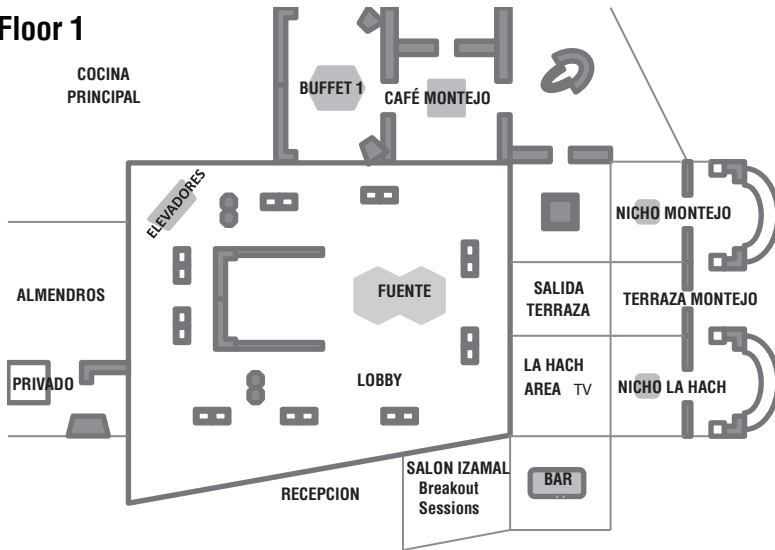

## Floor 2

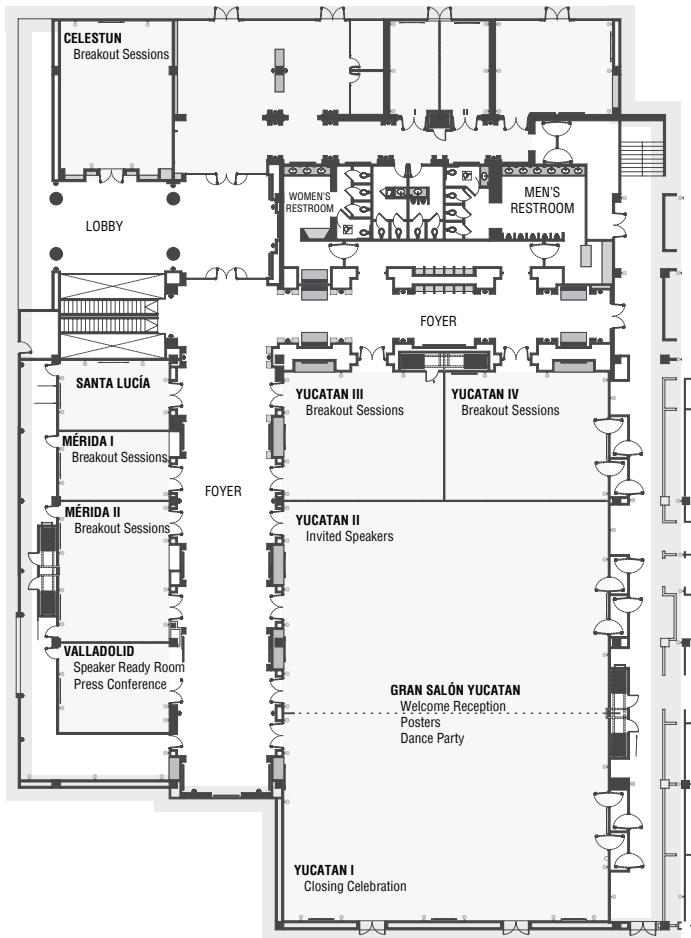

# Map of Merida

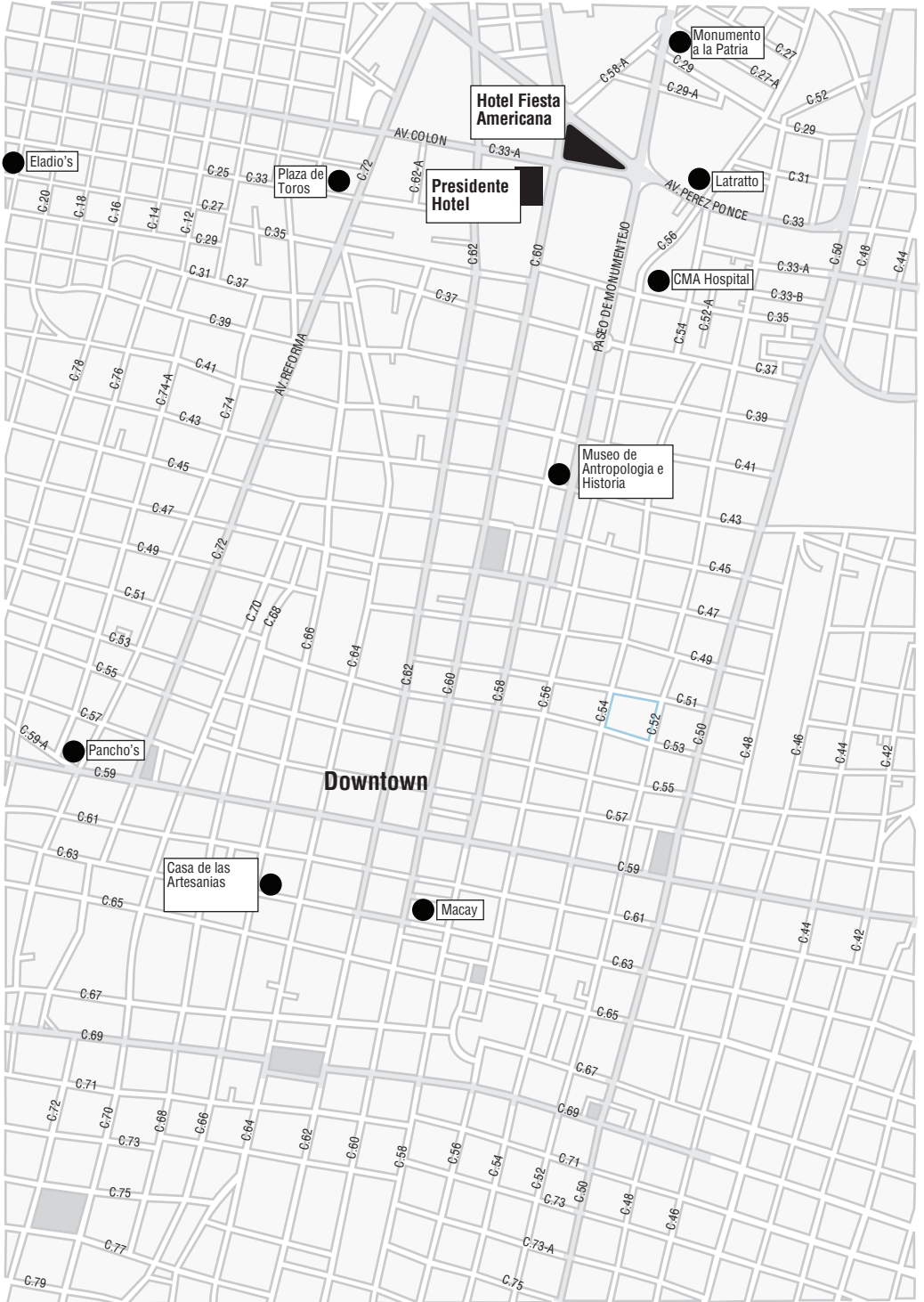

## Notes

## Notes

## Notes